

THE VERY BEST MADE HERE

Here in Idaho, our state-of-the-art facilities enable us to control every step of the manufacturing process, ensuring that the highest quality of premium pavers, walls, outdoor living kits and packaged concrete products are delivered to you.



FOLLOW US



[basalite.com](https://www.basalite.com)

1300 East Franklin Road

Meridian, ID 83642

basalite.boise@basalite.com

208-888-4050

©2024 Basalite® Concrete Products, LLC. All trademarks ® are registered trademarks. Brisa® wall systems are manufactured under license from Anchor Wall Systems, Inc. (AWS). "Brisa" and "Torpedo" are trademarks of AWS. The wall system blocks are covered by the AWS Limited Warranty. For a complete copy, visit your local dealer or see [anchorwall.com](https://www.anchorwall.com). Stonewall® II is a registered trademark of WestBlock Systems and a licensed product of WestBlock Development, LLC. Stonewall® II is protected under U.S. Patent D652.153, D652.154, D652.155, D652.531. Additional Patents pending in the U.S. and Canada. Rosetta® Step Collection is a registered trademarks of Rosetta®. BA502 2500 4/29/2024



PAVERS | WALLS | OUTDOOR LIVING KITS



GREAT HARDSCAPES START HERE®





Artisan Slate Pavers in Venice - see page 9

BUILDING VALUES

For almost 40 years, Basalite® has worked on growing our business by building relationships. We have created strong bonds with our dealers, masons, architects, engineers and licensed contractors. From working together with the common purpose of installing the finest hardscape products available, we have seen our products placed in settings that range from practical to magical. At Basalite®, we are committed to being the best in the industry. Our focus now, just as it was when we opened our doors all those years ago, is on service, quality and innovation. Those are the values that have made us the industry leader we are today and the same principles that will guide us far into the future.



CONTENTS

INTRODUCTION	
Inspiring Outdoor Spaces	03
PAVERS	
Artisan Slate Premier	07
Artisan Slate	09
Italian Renaissance	11
Plank Paver	13
San Francisco Cobblestone	15
Country Cobble	17
Circle Kits	19
Wood Grain	21
Bullnose	22
Mission	23
Heartland	25
Artisan Flagstone	26
PERMEABLE PAVERS	
Permeable Artisan Slate	27
Spec Pave 80	29
Spec Pave 100	31
RETAINING & LANDSCAPE WALLS	
StoneWall® II	33
StoneWall® II Column Kit	35
AB® Metro	37
AB® Courtyard	38
Brisa® Retaining Wall	39
Brisa® Freestanding Wall	41
Lakeland Standard and Lakeland II	43
Rosetta® Step Collection	45
Geowall™ Pro	47
Geowall™ Pro Beveled	49
Estate Wall	51
Terrace Wall	52
AB® Classic	53
OUTDOOR LIVING KITS	
StoneWall® II Fire Pit Kit	55
Necessaries™ Outdoor Living Kits	57
Necessaries™ Fire Pits Kits	59
ACCESSORIES	
Alliance Gator Products	61
PATTERNS	
Paver Patterns	63
INSTALLATION INSTRUCTIONS	
Typical Paver Installation	65
Permeable Paver Installation	65
StoneWall® II Installation	65
Typical Retaining Wall Installation	66
Brisa® Freestanding Wall Installation	66
Brisa® Freestanding Wall Installation	66

GREAT HARDSCAPES START HERE



Necessaries™ The Kitchen in Positano with Black Pearl granite countertop.
Outdoor Pizza Oven and Green Egg sold separately - visit basalite.com for more details

Basalite® sets the standard for hardscapes with our extensive collection of quality pavers, walls and outdoor living kits. Our large selection of styles, shapes, colors and textures allows you to transform patios, driveways, outdoor kitchens, pool areas and walkways into beautiful outdoor living areas.

Find inspiration for your next outdoor project with these designs showcasing real-life projects. Share your photos with us on Pinterest, Twitter, Facebook or LinkedIn.





Artisan Slate Premier Pavers in Positano, Brisa® Freestanding Wall in Flint and Necessaries™ Contemporary Fireplace kit in Desert - see pages 7, 39, 57



Artisan Slate Pavers in Positano - see page 9



Artisan Slate Pavers in Positano - see page 9



Mission Pavers in Positano - see page 23



Country Cobble Pavers in special order custom color - see page 17



San Francisco Cobblestone Circle Kit in Positano - see page 19

ARTISAN SLATE PREMIER



Positano



Positano



DESIGN IDEA
Create visual drama with a curving driveway.

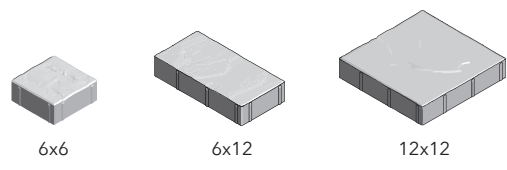

6x6 6x12 12x12

Name	Metric Units	U.S. Customary Units	Weight	Units/Pallet	Sq. Ft./Pallet
6x6	148mm W x 148mm L x 60mm H	5.83" W x 5.83" L x 2.375" H	7 lbs	448	108
6x12	148mm W x 298mm L x 60mm H	5.83" W x 11.73" L x 2.375" H	13.5 lbs	224	108
12x12	298mm W x 298mm L x 60mm H	11.73" W x 11.73" L x 2.375" H	20 lbs	128	122

For design consideration add 1.5mm or .06" to the W and L dimensions to allow for the spacers.

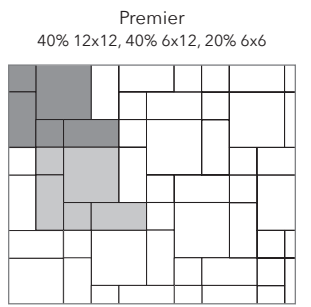

For additional patterns turn to page 63 and 64 or visit basalite.com.



POSITANO



TORINO

Printed colors shown in this brochure may vary from actual product colors. We recommend selecting colors from actual product samples.

ARTISAN SLATE



DESIGN IDEA

Make your space unique by using a sailor and soldier patterned border.



Positano



Positano

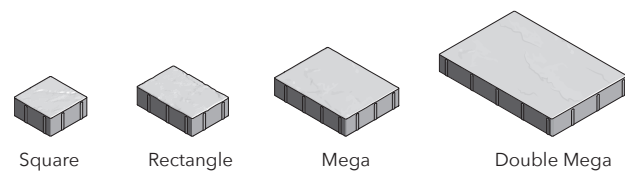

Name	Metric Units	U.S. Customary Units	Weight	Units/Pallet	Sq. Ft./Pallet
Square	138mm W x 138mm L x 60mm H	5.43" W x 5.43" L x 2.375" H	6 lbs	512	107
Rectangle	138mm W x 208mm L x 60mm H	5.43" W x 8.19" L x 2.375" H	8 lbs	384	121
Mega	208mm W x 278mm L x 60mm H	8.19" W x 10.94" L x 2.375" H	19 lbs	160	102
Double Mega	418mm W x 278mm L x 60mm H	16.4" W x 10.94" L x 2.375" H	27 lbs	96	120

For design consideration add 1.5mm or .06" to the W and L dimensions to allow for the spacers.

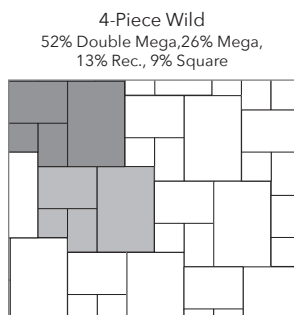

For additional patterns turn to page 63 and 64 or visit basalite.com.



Printed colors shown in this brochure may vary from actual product colors. We recommend selecting colors from actual product samples.

ITALIAN RENAISSANCE



Positano



Torino



Positano

DESIGN IDEA

Create your own intimate campground by adding a StoneWall® II fire pit kit.

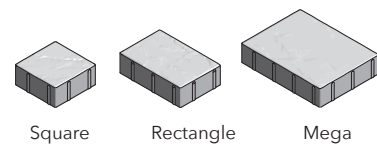

Name	Metric Units	U.S. Customary Units	Weight	Units/Pallet	Sq. Ft./Pallet
Square	138mm W x 138mm L x 60mm H	5.43" W x 5.43" L x 2.375" H	6 lbs	512	107
Rectangle	138mm W x 208mm L x 60mm H	5.43" W x 8.19" L x 2.375" H	8 lbs	384	121
Mega	208mm W x 278mm L x 60mm H	8.19" W x 10.94" L x 2.375" H	19 lbs	160	102

For design consideration add 1.5mm or .06" to the W and L dimensions to allow for the spacers.

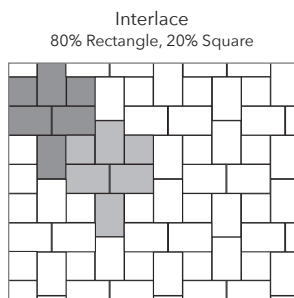

For additional patterns turn to page 63 and 64 or visit basalite.com.



Printed colors shown in this brochure may vary from actual product colors. We recommend selecting colors from actual product samples.

PLANK PAVER



DESIGN FEATURE

Our 3x18 Plank Paver is perfect for high traffic areas.



Pescadero and Mt. Whitney (Special Order)

Pescadero and Mt. Whitney (Special Order)

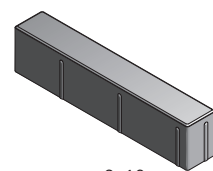

3x18

Name	Metric Units	U.S. Customary Units	Weight	Units/Pallet	Sq. Ft./Pallet
3x18	73mm W x 448mm L x 100mm H	2.87" W x 17.64" L x 3.94" H	16 lbs	168	60

For design consideration add 1.5mm or .06" to the W and L dimensions to allow for the spacers.

Running Bond
100% 3x18

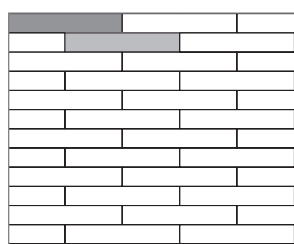

For additional patterns turn to page 63 and 64 or visit basalite.com.



SAN FRANCISCO COBBLESTONE



DESIGN IDEA

Gain dramatic appeal by combining texture and color that complement your home's exterior.



Torino



Torino

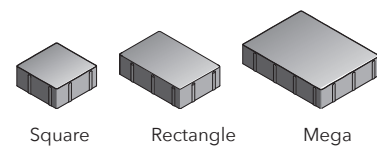

Square Rectangle Mega

Name	Metric Units	U.S. Customary Units	Weight	Units/Pallet	Sq. Ft./Pallet
Square	138mm W x 138mm L x 60mm H	5.43" W x 5.43" L x 2.375" H	6 lbs	512	107
Rectangle	138mm W x 208mm L x 60mm H	5.43" W x 8.19" L x 2.375" H	8 lbs	384	121
Mega	208mm W x 278mm L x 60mm H	8.19" W x 10.94" L x 2.375" H	19 lbs	160	102

For design consideration add 1.5mm or .06" to the W and L dimensions to allow for the spacers.

Interlace
75% Rectangle, 25% Square

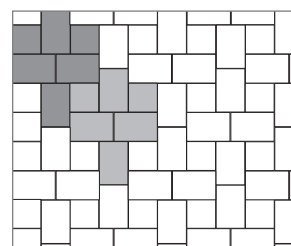

For additional patterns turn to page 63 and 64 or visit basalite.com.



POSITANO



TORINO



VENICE
(special order)



MOCHA
(special order)

Printed colors shown in this brochure may vary from actual product colors. We recommend selecting colors from actual product samples.

COUNTRY COBBLE



DESIGN IDEA
Create visual drama with contrasting colors.



Positano



Torino

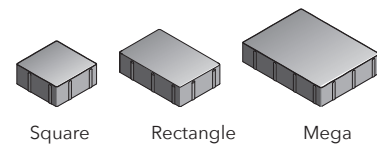

Square Rectangle Mega

Name	Metric Units	U.S. Customary Units	Weight	Units/Pallet	Sq. Ft./Pallet
Square	138mm W x 138mm L x 60mm H	5.43" W x 5.43" L x 2.375" H	6 lbs	512	107
Rectangle	138mm W x 208mm L x 60mm H	5.43" W x 8.19" L x 2.375" H	8 lbs	384	121
Mega	208mm W x 278mm L x 60mm H	8.19" W x 10.94" L x 2.375" H	19 lbs	160	102

For design consideration add 1.5mm or .06" to the W and L dimensions to allow for the spacers.

Random One
40% Mega, 20% Rec, 40% Square

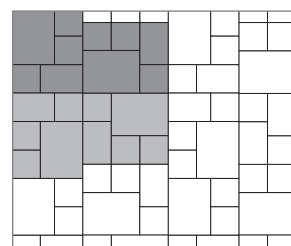

For additional patterns turn to page 63 and 64 or visit basalite.com.



POSITANO



TORINO



VENICE
(special order)



MOCHA
(special order)

Printed colors shown in this brochure may vary from actual product colors. We recommend selecting colors from actual product samples.

CIRCLE KITS



DESIGN FEATURE
Basalite Circle Kits make 11 foot circles and require no cutting.

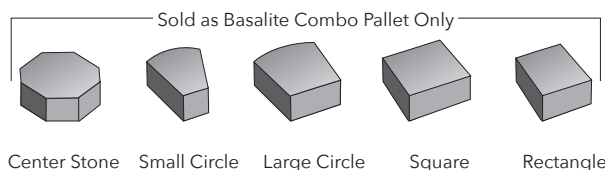

Name	Metric Units	U.S. Customary Units	Weight	Units/Pallet	Sq. Ft./Pallet
Center Stone	139mm W x 139mm L x 60mm H	5.47" W x 5.47" L x 2.375" H	4.3 lbs	6 (Center Stone), 8	Makes one 11 foot circle
Small Circle	156mm W x 139mm L x 60mm H	6.14" W x 5.47" L x 2.375" H	4.2 lbs	(Small Circle), 240 (Large Circle), 120 (Square),	
Large Circle	130mm W x 139mm L x 60mm H	5.11" W x 5.47" L x 2.375" H	4.2 lbs	112 (Rec.) for a full pallet	
Square	139mm W x 139mm L x 60mm H	5.47" W x 5.47" L x 2.375" H	5.5 lbs	quantity of 448 pieces	
Rectangle	119mm W x 139mm L x 60mm H	4.69" W x 5.47" L x 2.375" H	4.7 lbs		

For design consideration add 1.5mm or .06" to the W and L dimensions to allow for the spacers.

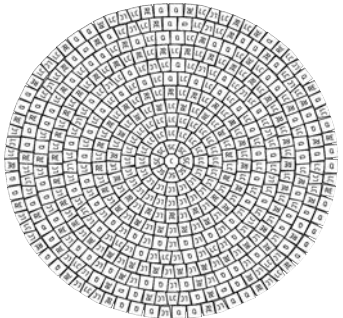

Printed colors shown in this brochure may vary from actual product colors. We recommend selecting colors from actual product samples.

WOOD GRAIN PAVER



Driftwood

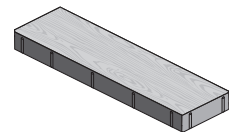

Wood Grain

Name	Metric Units	U.S. Customary Units	Weight	Units/Pallet	Sq. Ft./Pallet
Wood Grain	148mm W x 448mm L x 60mm H	5.83" W x 17.64" L x 2.375" H	19 lbs	112	80

For design consideration add 1.5mm or .06" to the W and L dimensions to allow for the spacers.

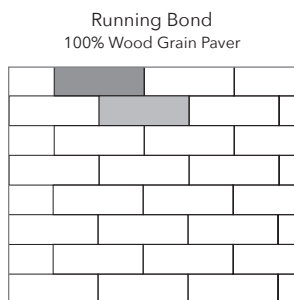

For additional patterns visit basalite.com.

BULLNOSE

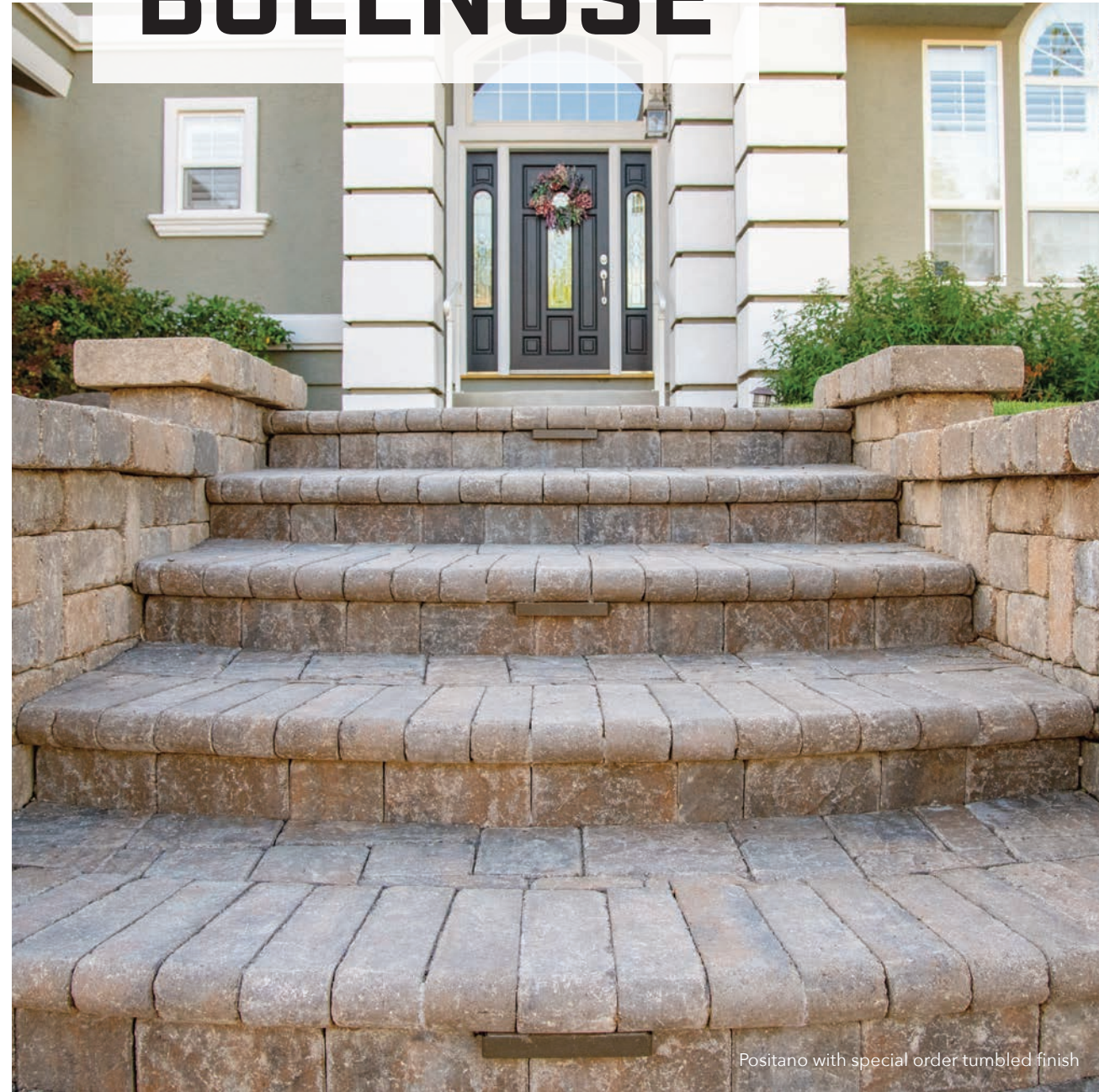

Positano with special order tumbled finish

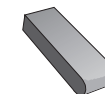

Bullnose

Name	Metric Units	U.S. Customary Units	Weight	Units/Pallet	Sq. Ft./Pallet
Bullnose	98mm W x 300mm L x 60mm H	3.86" W x 11.81" L x 2.375" H	8 lbs	128	42.5

For design consideration add 1.5mm or .06" to the W and L dimensions.

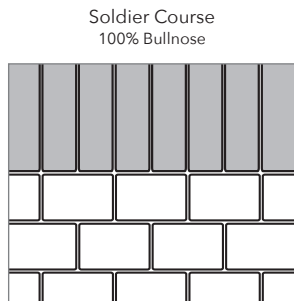

MISSION



Positano and Venice with Lamp Black Border



special order custom colors



DESIGN FEATURE

Mission pavers can be arranged in several appealing patterns.

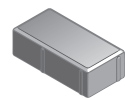

Mission

Name	Metric Units	U.S. Customary Units	Weight	Units/Pallet	Sq. Ft./Pallet
Mission	98mm W x 198mm L x 60mm H	3.85" W x 7.795" L x 2.375" H	7 lbs	528	113

For design consideration add 1.5mm or .06" to the W and L dimensions to allow for the spacers.

45° Herringbone
100% Mission

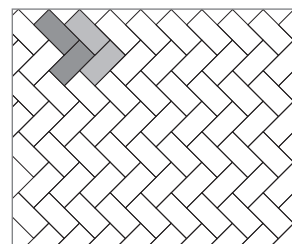

For additional patterns turn to page 63 and 64 or visit basalite.com.

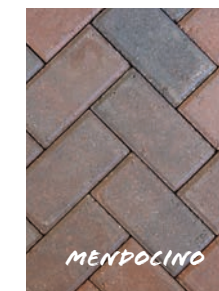
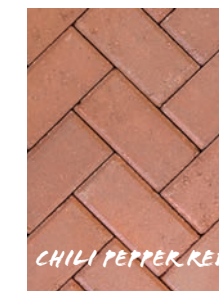
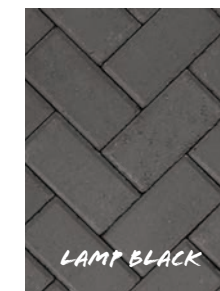
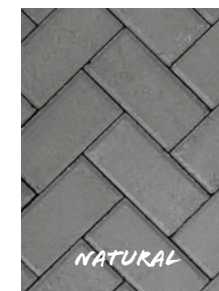
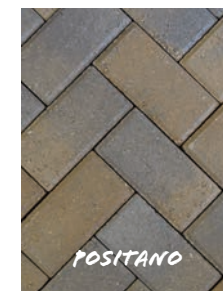

Printed colors shown in this brochure may vary from actual product colors. We recommend selecting colors from actual product samples.

HEARTLAND PAVER



Positano



ARTISAN FLAGSTONE



Positano



Sold as Basalite Combo Pallet Only

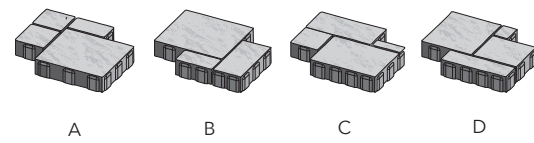

Name	Metric Units	U.S. Customary Units	Weight	Units/Pallet	Sq. Ft./Pallet
A	307mm W x 377mm L x 60mm H	12.09" W x 14.84" L x 2.375" H	28 lbs	24 (A), 32 (B), 24 (C) & 16 (D) for a full pallet quantity of 104 pieces	104
B	307mm W x 377mm L x 60mm H	12.09" W x 14.84" L x 2.375" H	28 lbs		
C	307mm W x 377mm L x 60mm H	12.09" W x 14.84" L x 2.375" H	28 lbs		
D	307mm W x 377mm L x 60mm H	12.09" W x 14.84" L x 2.375" H	28 lbs		

For design consideration add 3.5mm or .14" to the W and L dimensions to allow for the spacers.

Heartland
100% Heartland



Sold as Basalite Combo Pallet Only

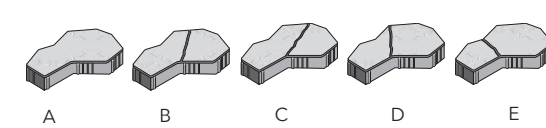

Name	Metric Units	U.S. Customary Units	Weight	Units/Pallet	Sq. Ft./Pallet
A	293mm W x 419mm L x 60mm H	11.05" W x 16.5" L x 2.375" H	23 lbs	20 pieces of A, B, C, D & E are on one pallet for a full quantity of 100 pieces	81
B	293mm W x 419mm L x 60mm H	11.05" W x 16.5" L x 2.375" H	23 lbs		
C	293mm W x 419mm L x 60mm H	11.05" W x 16.5" L x 2.375" H	23 lbs		
D	293mm W x 419mm L x 60mm H	11.05" W x 16.5" L x 2.375" H	23 lbs		
E	293mm W x 419mm L x 60mm H	11.05" W x 16.5" L x 2.375" H	23 lbs		

For design consideration add 1.5mm or .06" to the W and L dimensions to allow for the spacers.

Artisan Flagstone
100% Artisan Flagstone

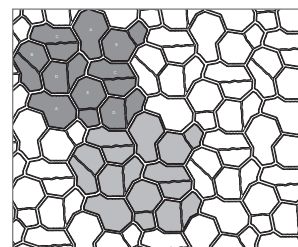

PERMEABLE ARTISAN SLATE



DESIGN FEATURE

Permeable Artisan Slate allows water to drain naturally into the surface, reducing storm water runoff and its contaminants from entering our waterways.



Positano



Positano

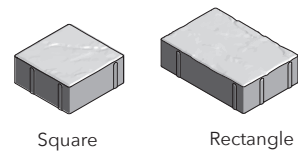

Square

Rectangle

Interlace
70% Rectangle and 30% Square

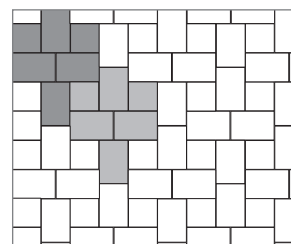

Name	Metric Units	U.S. Customary Units	Weight	Units/Pallet	Sq. Ft./Pallet
Square	138mm W x 138mm L x 60mm H	5.43" W x 5.43" L x 3.125" H	6lbs	512	107
Rectangle	138mm W x 208mm L x 60mm H	5.43" W x 8.19" L x 3.125" H	8 lbs	384	121

For design consideration add 1.5mm or .06" to the W and L dimensions to allow for the spacers.



POSITANO
(special order)

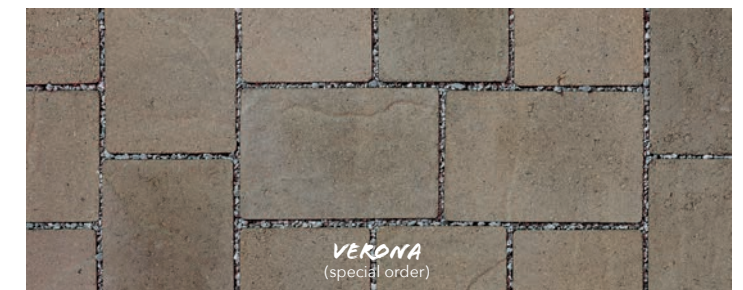

VERONA
(special order)

Printed colors shown in this brochure may vary from actual product colors. We recommend selecting colors from actual product samples.

SPEC PAVE 80



Positano/Venice blend



Venice



DESIGN FEATURE

Spec Pave is recognized as an EPA approved structural BMP (Best Management Practice), and is ADA compliant.

PERMEABLE PAVERS / SMOOTH & TEXTURED

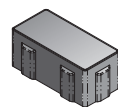

80 mm

Spacer on Stone Herringbone
100% Spec Pave 80

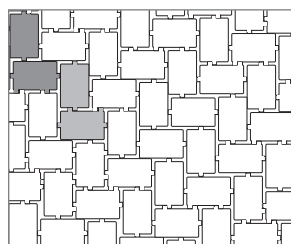

Name	Metric Units	U.S. Customary Units	Weight	Units/Pallet	Sq. Ft./Pallet
80 mm	98mm W x 196mm L x 80mm H	3.483" W x 7.342" L x 3.15" H	6.5 lbs	350	72

For design consideration add 9.5mm or .375" to the W and L dimensions to allow for the spacers.



SPEC PAVE 100



DESIGN FEATURE

Complies with ICPI and ASCE requirement for Aspect Ratio for vehicular loading.

PERMEABLE PAVERS / SMOOTH & TEXTURED



Mendocino Textured special order



Positano Textured special order

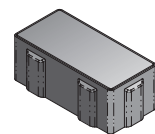

100 mm

Spacer on Stone Herringbone
100% Spec Pave 80

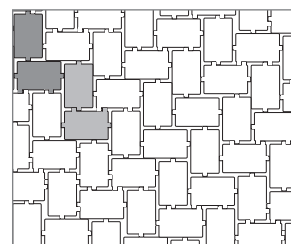

Name	Metric Units	U.S. Customary Units	Weight	Units/Pallet	Sq. Ft./Pallet
100 mm	140mm W x 279mm L x 100mm	5.5" W x 11" L x 3.94" H	18 lbs	192	80

For design consideration add 9.5mm or .375" to the W and L dimensions to allow for the spacers.

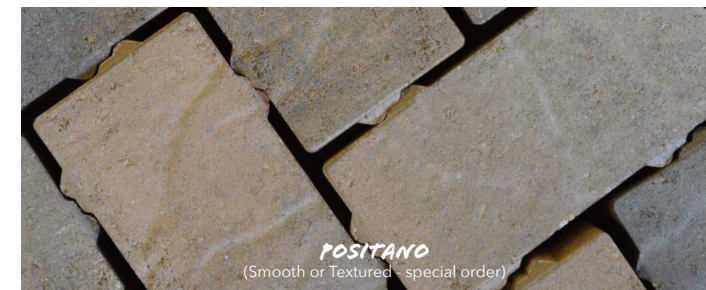

POSITANO
(Smooth or Textured - special order)

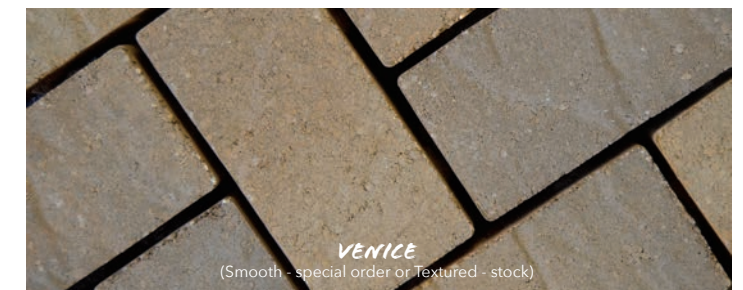

VENICE
(Smooth - special order or Textured - stock)

Printed colors shown in this brochure may vary from actual product colors. We recommend selecting colors from actual product samples.

STONEWALL® II WALL SYSTEMS



Positano



Torino



Positano

DESIGN FEATURE
Stonewall® II can be built as a freestanding or retaining wall.

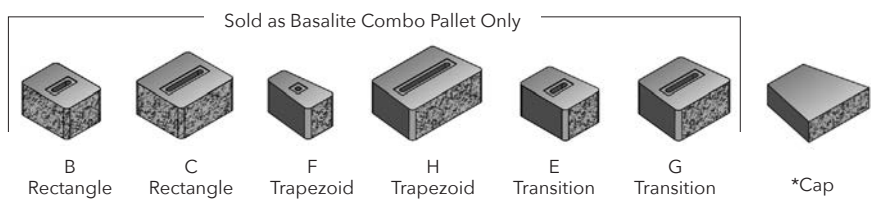

Name	Metric Units	U.S. Customary Units	Weight	Units/Pallet	Sq. Ft./Pallet
B	203mm W x 153mm H x 267mm L	8" W x 6" H x 10.5" L	34 lbs	Varies	33
C	305mm W x 153mm H x 267mm L	12" W x 6" H x 10.5" L	50 lbs		
F	153/102mm W x 153mm x H x 267mm L	6/4" W x 6" H x 10.5" L	21 lbs		
H	406/356mm W x 153mm H x 267mm L	16/14" W x 6" H x 10.5" L	64 lbs		
E	203/178mm W x 153mm H x 267mm L	8/7" W x 6" H x 10.5" L	32 lbs		
G	305/279mm W x 153mm H x 267mm L	12/11" W x 6" H x 10.5" L	49 lbs		
*Cap	343/203mm W x 76mm H x 305mm L	13.5/8" W x 3" H x 12" L	24 lbs	128	114 LF

* Palletized and sold separately.



POSITANO



TORINO



VERONA

Printed colors shown in this brochure may vary from actual product colors. We recommend selecting colors from actual product samples.

STONEWALL® II COLUMN KIT



Positano with special order Pewter Column Cap (sold separately)

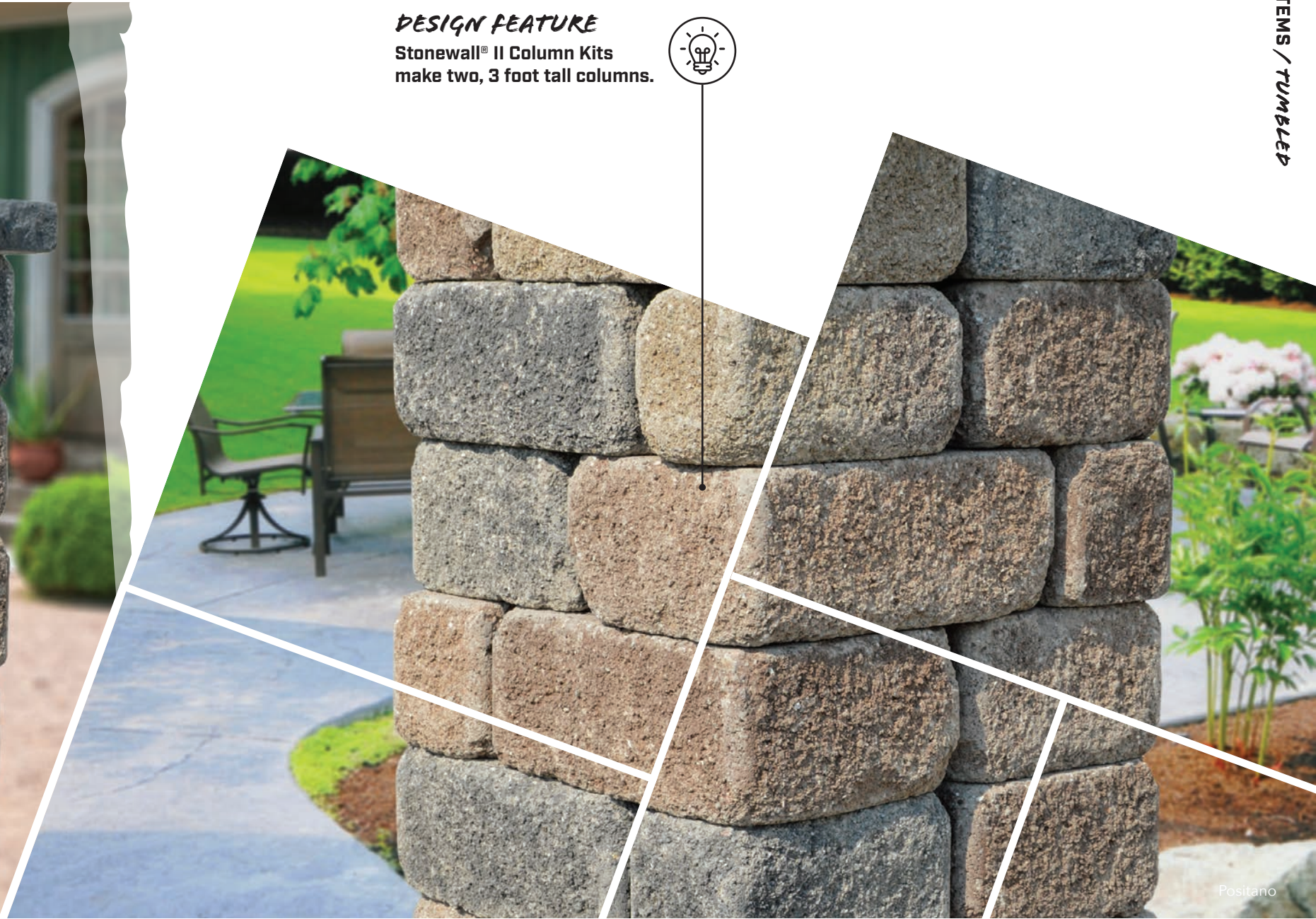

DESIGN FEATURE
Stonewall® II Column Kits
make two, 3 foot tall columns.

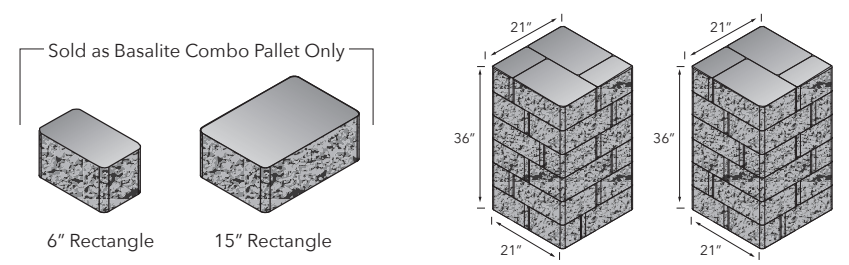

Name	Metric Units	U.S. Customary Units	Weight	Units/Pallet
6" Rectangle	153mm W x 153mm H x 267mm L	6" W x 6" H x 10.5" L	28 lbs	24 (6" Rectangle) and 24 (15" Rectangle) for a full pallet quantity of 48 pieces
15" Rectangle	381mm W x 153mm H x 267mm L	15" W x 6" H x 10.5" L	70 lbs	

Each column is 21" x 21" square. Kit makes two, 3-foot tall columns.



AB[®] METRO

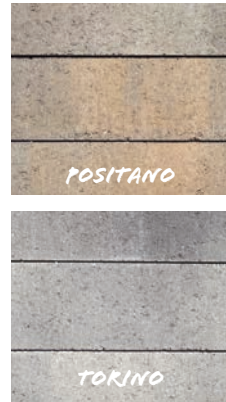

AB[®] COURTYARD



WALL SYSTEMS / SMOOTH & TUMBLED

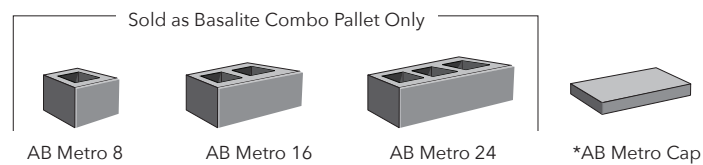

Name	Metric Units	U.S. Customary Units	Weight	Units/Pallet	Sq. Ft./Pallet
AB Metro 8	203mm W x 203mm L x 152mm H	8" W x 8" L x 6" H	20 lbs	15 (Metro 8), 15 (Metro 16) and 15 (Metro 24) for a full pallet quantity of 45 pieces	30
AB Metro 16	400mm W x 203mm L x 152mm H	16" W x 8" L x 6" H	40 lbs		
AB Metro 24	609mm W x 203mm L x 152mm H	24" W x 8" L x 6" H	60 lbs		
*AB Metro Cap	457mm W x 279mm L x 76mm H	18" W x 11" L x 3" H	50 lbs	64	96 LF

* Palletized and sold separately.

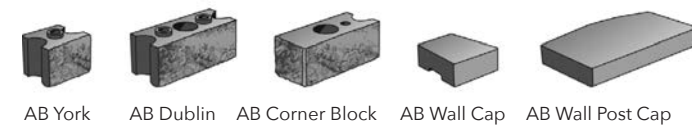

Name	Metric Units	U.S. Customary Units	Weight	Units/Pallet	Sq. Ft./Pallet
AB York	178mm W x 229/188mm L x 152mm H	7" W x 9"/7.4" L x 6" H	20 lbs	90	30.822
AB Dublin	178mm W x 417mm L x 152mm H	7" W x 16.4" L x 6" H	39 lbs	40	27.397
AB Corner Block	178mm W x 376mm L x 152mm H	7" W x 14.8" L x 6" H	42 lbs	30	
AB Wall Cap	305mm W x 237/179mm L x 89mm H	12" W x 9.34"/7.06" L x 3.5" H	22 lbs	120	
AB Wall Post Cap	305mm W x 610mm L x 76mm H	12" W x 24" L x 3" H	65 lbs	24	

Units are packaged separately to allow them to be used individually or to blend them together for a variety of patterns. Use the AB Dublin for straight walls and the AB York for building curved walls.*AB Corner Block requires 4 corners per course for each post. *AB Wall Cap requires 2 caps for each post.

special order custom color

BRISA[®] RETAINING WALL



DESIGN IDEA
Use Brisa[®] retaining walls to create stunning terraced walls.



Sandstone



Torino

Sold as Basalite Combo Pallet Only

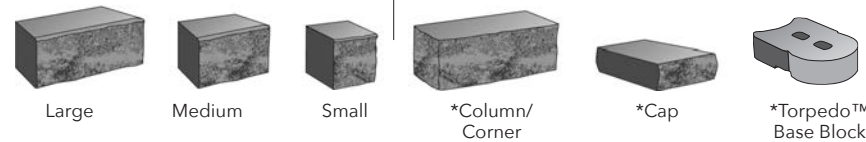

Name	Metric Units	U.S. Customary Units	Weight	Units/Pallet	Sq. Ft./Pallet
Large	178mm W x 152mm H x 406mm L	7" W x 6" H x 16" L	52 lbs	30 (Large), 15 (Medium) & 15 (Small) for a full pallet quantity of 60 pieces.	30
Medium	178mm W x 152mm H x 254mm L	7" W x 6" H x 10" L	31 lbs		
Small	178mm W x 152mm H x 152mm L	7" W x 6" H x 6" L	20 lbs		
*Column/Corner	406mm W x 152mm H x 184mm L	7.25" W x 6" H x 16" L	75 lbs	28	28
*Cap	305mm W x 76mm H x 191mm L	12" W x 3" H x 7.5" L	22 lbs	126	78 LF
*Torpedo™	254mm W x 103mm H x 445mm L	17.5" W x 4" H x 10" L	47 lbs	48	63 LF

* Palletized and sold separately.



Printed colors shown in this brochure may vary from actual product colors. We recommend selecting colors from actual product samples.

BRISA® FREESTANDING WALL



special order custom color



DESIGN IDEA
Use Brisa® freestanding walls to create seating areas, columns, borders, and courtyards.



Flint

Sold as Basalite Combo Pallet Only

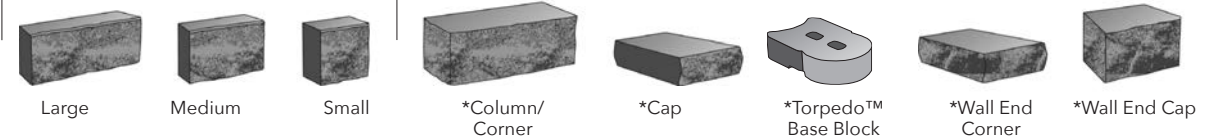

Name	Metric Units	U.S. Customary Units	Weight	Units/Pallet	Sq. Ft./Pallet
Large	102mm W x 152mm H x 406mm L	4" W x 6" H x 16" L	70 lbs	60 (Large), 30 (Medium) & 30 (Small) for a full pallet quantity of 120 pieces.	30 (see note below)
Medium	102mm W x 152mm H x 254mm L	4" W x 6" H x 10" L	45 lbs		
Small	102mm W x 152mm H x 152mm L	4" W x 6" H x 6" L	20 lbs		
*Column/Corner	184mm W x 152mm H x 406mm L	7.25" W x 6" H x 16" L	75 lbs	28	28
*Cap	305mm W x 76mm H x 191mm L	12" W x 3" H x 7.5" L	22 lbs	126	78 LF
*Torpedo™	445mm W x 103mm H x 254mm L	17.5" W x 4" H x 10" L	47 lbs	48	63 LF
*Wall End Cap	184mm W x 76mm H x 305mm L	7.25" W x 3" H x 12" L	22 lbs	36	78 LF
*Wall End Corner	184mm W x 152mm H x 241mm L	7.25" W x 6" H x 9.5" L	36 lbs	42	28 LF

* Palletized and sold separately. NOTE: One pallet constructs 30 sq ft of finished Freestanding Wall.



FLINT

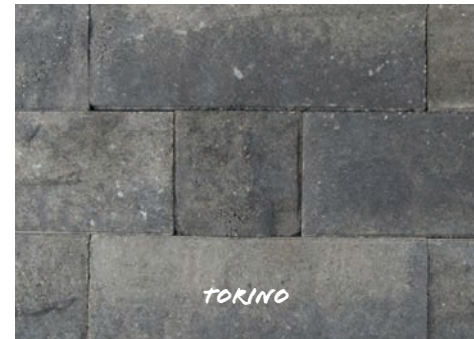

TORINO



SANDSTONE

Printed colors shown in this brochure may vary from actual product colors. We recommend selecting colors from actual product samples.

LAKELAND® WALL SYSTEMS



Positano



DESIGN FEATURE
Lakeland® wall systems can be used to create freestanding walls.



Note: Fire pit is custom and not available as a kit.

Torino

Sold as Basalite Combo Pallet Only

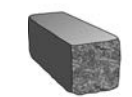

Lakeland™ II Small

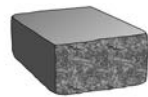

Lakeland™ II Medium

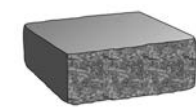

*Lakeland™ Standard

Name	Metric Units	U.S. Customary Units	Weight	Units/Pallet	Sq. Ft./Pallet
Small	102mm W x 102mm H x 203mm L	4" W x 4" H x 8" L	10 lbs	80 in each size for a full pallet quantity of 160 pieces.	26.4
Medium	203mm W x 102mm H x 203mm L	8" W x 4" H x 8" L	20 lbs		
*Standard	305mm W x 102mm H x 203mm L	12" W x 4" H x 8" L	31 lbs	80	26.4

*Palletized and sold separately.



POSITANO



TORINO



VERONA

Printed colors shown in this brochure may vary from actual product colors. We recommend selecting colors from actual product samples.

ROSETTA® STEP COLLECTION



special order custom color



special order custom color



DESIGN FEATURE

The Rosetta® Step Collection provides the rugged attractiveness of natural stone, but with the safety and comfort of a uniform rise.

Sold as Basalite Combo Pallet Only



Name	Metric Units	U.S. Customary Units	Weight	Units/Pallet
Irregular Step A	432mm W x 140mm H x 1077mm L	1'-5" W x 5.5" H x 3'-6" L	289 lbs	1 in each size for a total of 6 pieces.
Irregular Step B	559mm W x 140mm H x 1372mm L	1'-10" W x 5.5" H x 4'-6" L	391 lbs	
Irregular Step C	610mm W x 140mm H x 1219mm L	2' W x 5.5" H x 4' L	424 lbs	
Irregular Step D	610mm W x 140mm H x 1524mm L	2' W x 5.5" H x 5' L	508 lbs	
Irregular Step E	660mm W x 140mm H x 1067mm L	2'-2" W x 5.5" H x 3'-6" L	390 lbs	
Irregular Step F	711mm W x 140mm H x 1219mm L	2'-4" W x 5.5" H x 4' L	415 lbs	
Dimensional*	457mm W x 178mm H x 1219mm L	18" W x 7" H x 48" L	455 lbs	6

*Palletized and sold separately.

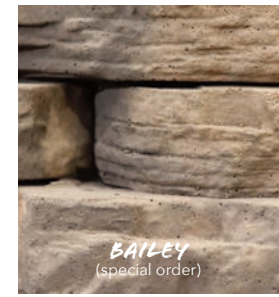
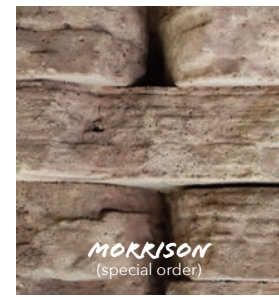

Printed colors shown in this brochure may vary from actual product colors. We recommend selecting colors from actual product samples.

GEOWALL™ PRO



DESIGN FEATURE

Geowall™ has two setback positions for near-vertical or battered wall construction.

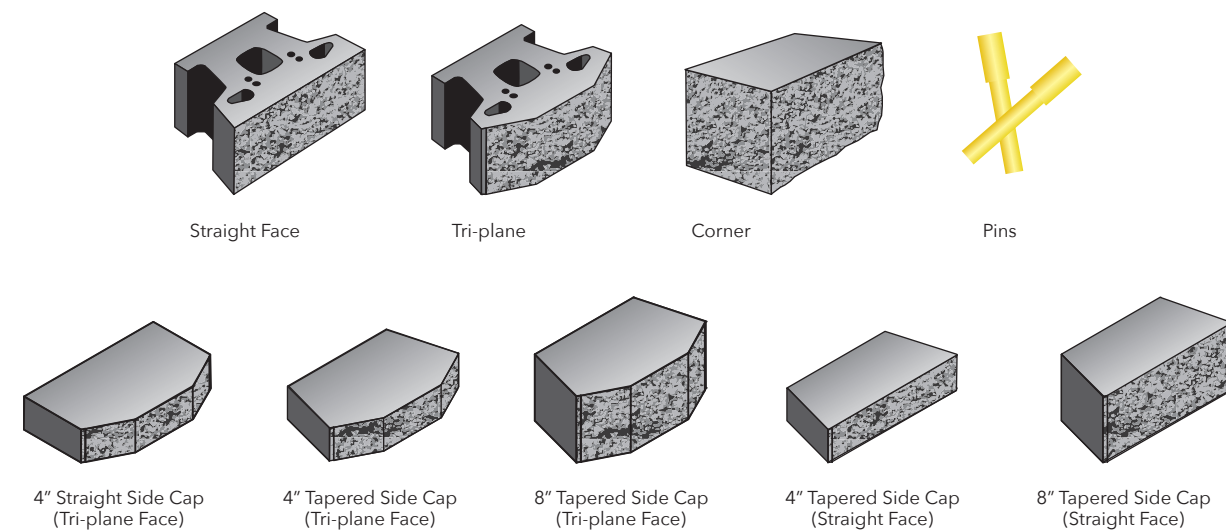

Name	Metric Units	U.S. Customary Units	Weight	Units/Pallet	Face Area/Unit
Straight Face	457mm W x 203mm H x 305mm L	18" W x 8" H x 12" L	93 lbs	36	1 SF
Tri-plane	457mm W x 203mm H x 305mm L	18" W x 8" H x 12" L	89 lbs	36	1 SF
Corner	457mm W x 203mm H x 229mm L	18" W x 8" H x 9" L	101 lbs	40	1 SF
4" Straight Side Cap (Tri-plane Face)	457mm W x 102mm H x 267mm L	18" W x 4" H x 10.5" L	46 lbs	80	1/2 SF
4" Tapered Side Cap (Tri-plane Face)	356/457mm W x 102mm H x 267mm L	14/18" W x 4" H x 10.5" L	46 lbs	80	1/2 SF
8" Tapered Side Cap (Tri-plane Face)	356/457mm W x 203mm H x 267mm L	14/18" W x 8" H x 10.5" L	95 lbs	40	1 SF
4" Tapered Side Cap (Straight Face)	356/457mm W x 102mm H x 267mm L	14/18" W x 4" H x 10.5" L	46 lbs	40	1/2 SF
8" Tapered Side Cap (Straight Face)	356/457mm W x 203mm H x 267mm L	14/18" W x 8" H x 10.5" L	95 lbs	80	1 SF
Pins (Included)	12.7mm W x 95mm L	.50" W x 3.75" L	-	-	-



Printed colors shown in this brochure may vary from actual product colors. We recommend selecting colors from actual product samples.

GEOWALL™ PRO BEVELED



special order custom color



DESIGN FEATURE
Geowall™ has two setback positions for near-vertical or battered wall construction.



special order custom color

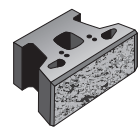

Straight Face

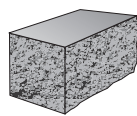

Corner



Pins

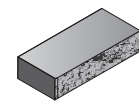

4" Straight Side Cap (Straight Face)

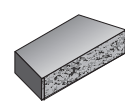

4" Tapered Side Cap (Straight Face)

Name	Metric Units	U.S. Customary Units	Weight	Units/Pallet	Sq. Ft./Pallet
Straight Face	457mm W x 203mm H x 305mm L	18" W x 8" H x 12" L	89 lbs	36	36
Corner	457mm W x 203mm H x 229mm L	18" W x 8" H x 9" L	101 lbs	40	60
Pins	12.7mm W x 95mm L	.50" W x 3.75" L	-	-	-
4" Straight Side Cap	457mm W x 102mm H x 267mm L	18" W x 4" H x 10.5" L	45 lbs	60	40
4" Tapered Side Cap	356/457mm W x 102mm H x 267mm L	14/18" W x 4" H x 10.5" L	46 lbs	80	35.5

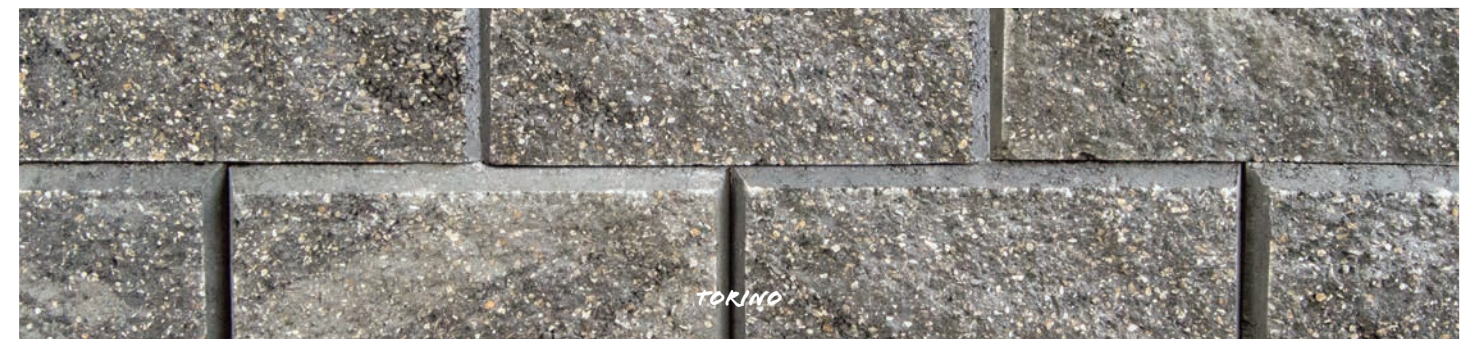

Printed colors shown in this brochure may vary from actual product colors. We recommend selecting colors from actual product samples.

ESTATE RETAINING WALL



special order custom color

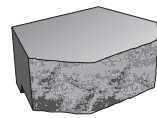

Tri-Plane

Name	Metric Units	U.S. Customary Units	Weight	Units/Pallet	Sq. Ft./Pallet
Tri-Plane	406mm W x 153mm H x 264mm L	16" W x 6" H x 10.375" L	50 lbs	60	40

TERRACE RETAINING WALL



special order custom color

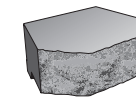

Tri-Plane

Name	Metric Units	U.S. Customary Units	Weight	Units/Pallet	Sq. Ft./Pallet
Tri-Plane	295mm W x 103mm H x 229mm L	11.625" W x 4" H x 9" L	22 lbs	100	33

Printed colors shown in this brochure may vary from actual product colors. We recommend selecting colors from actual product samples.

AB[®] CLASSIC



special order custom color



DESIGN FEATURE

The hollow core offers superior drainage and easier handling for faster installation.



special order custom color

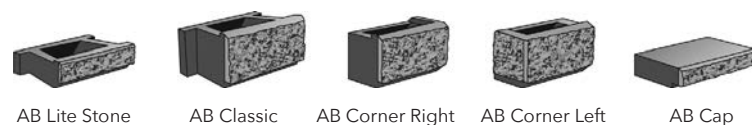

AB Lite Stone AB Classic AB Corner Right AB Corner Left AB Cap

Name	Metric Units	U.S. Customary Units	Weight	Units/Pallet
AB Lite Stone	305mm W x 102mm H x 448mm L	12" W x 17.625" L x 4" H	35 lbs	64
AB Classic	305mm W x 203mm H x 448mm L	12" W x 17.625" L x 8" H	75 lbs	32
AB Corner Right	203mm W x 203mm H x 400mm L	8" W x 5.75" L x 8" H	50 lbs	40
AB Corner Left	203mm W x 203mm H x 400mm L	8" W x 5.75" L x 8" H	50 lbs	40
AB Cap	305mm W x 102mm H x 448mm L	12" W x 17.625" L x 4" H	55 lbs	64

Units are packaged separately to allow them to be used individually or to blend them together. All units are engineered with a 6 degree setback.



Printed colors shown in this brochure may vary from actual product colors. We recommend selecting colors from actual product samples.

STONEWALL® II FIRE PIT KITS



Positano

DESIGN FEATURE

Our StoneWall® II fire pit kit is an easy to install project that includes all of the materials you need to build your own intimate campfire.



Positano

Sold as Basalite Combo Pallet Only



Unit F

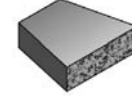

Cap

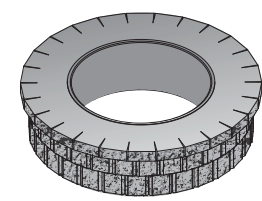

Name	Metric Units	U.S. Customary Units	Weight	Units/Pallet
21" Kit Unit F	153/102mm W x 153mm H x 267mm L	6/4" W x 6" H x 10.5" L	21 lbs	87 (Unit F) and 14 (Cap) for a full pallet quantity of 101 pieces
21" Kit Cap	343/203mm W x 76mm H x 254mm L	13.5"/8" W x 3" H x 12" L	24 lbs	

61" Width x 21" tall. Inside Diameter is 35". Kit is three courses plus cap.



POSITANO

Printed colors shown in this brochure may vary from actual product colors. We recommend selecting colors from actual product samples.

NECESSARIES™ OUTDOOR LIVING KITS



DESIGN FEATURE
Each kit comes with everything you need to build!



Special Order Custom Color



Necessaries™ Outdoor Living Kits is a collection of affordable, ready-to-assemble outdoor fireplaces, waterfalls, bars, tables, fire pits, pillars, seat walls and outdoor kitchens. Visit basalite.com to view all available kits.



Printed colors shown in this brochure may vary from actual product colors. We recommend selecting colors from actual product samples.

NECESSARIES™ FIRE PIT KITS



Special Order Custom Color

GRAND AND VICTORIAN FIRE PIT KITS - EACH KIT SOLD SEPARATELY

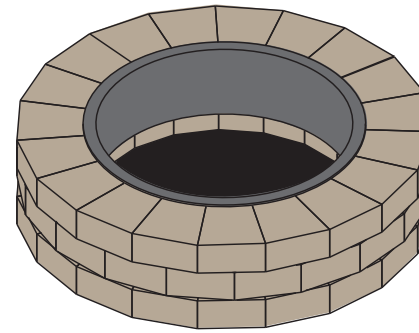

Grand Fire Ring Kit With Ring

- Interior: 31" diameter
- Heavy gauge, U.S. Park Service quality solid steel insert protects block

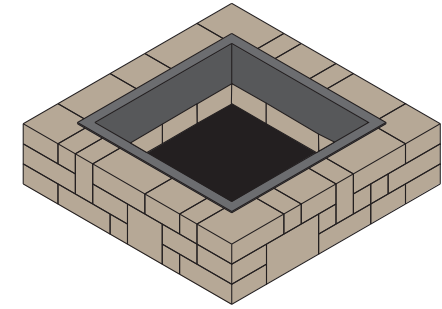

Victorian Fire Pit Kit With Ring

- Four-piece, heavy gauge, solid steel insert protects block

Name	Metric Units	U.S. Customary Units	Weight	Pallets
Grand Fire Ring Kit	1219mm W x 305mm H	448" W x 12" H	1050 lbs	1
Victorian Fire Pit Kit With Ring	1219mm W x 305mm H x 1219mm L	48" W x 12" H x 48" L	1000 lbs	1

GRAND AND VICTORIAN ACCESSORIES - SOLD SEPARATELY

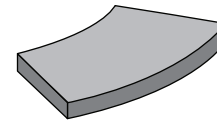

- Grand Limestone Caps
- 52" dia., 2.25" thick
 - Sold as a full set of 8 pieces
 - Silver Creek chiseled edge in limestone
 - Approximate weight 31 lbs
 - 1 pallet

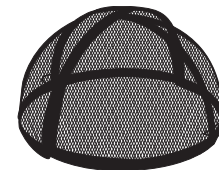

- Grand E-Z Access Spark Screen
- 40" W x 18" H.
 - Approximate weight 22 lbs.
 - Keeps ash and sparks in, debris out
 - Hinged for easy access

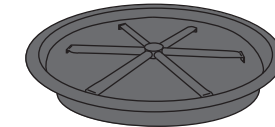

- Grand Firegear 29" Round Pan With 22" Stainless Steel Burning Spur
- Match throw ignition kit

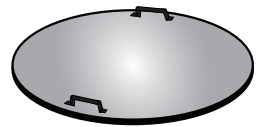

- Grand Galvanized Steel Cover
- Keeps children, animals and debris out
 - Heavy galvanized steel covers interior
 - With or without slot for cooking grate.

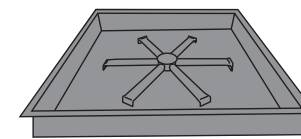

- Victorian Firegear 32" Square Pan With 22" Stainless Steel Burning Spur
- Match throw ignition kit

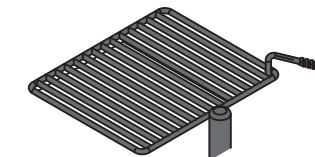

- Swivel Cooking Grate
- Heavy guage welded steel construction
 - ADA compliant
 - Removable
 - Anti-theft feature
 - For use with Grand or Victorian Fire Pits



- Fire Pits Log Set (log set only)
- Grand Canyon logs
 - For use with Grand or Victorian Fire Pits



SUPERSAND G2
For residential applications. This new generation of intelligent polymers neutralizes haze and dust. No blower is needed and the intelligent polymeric sand requires only one watering. Supersand G2 is recommended for a variety of uses including pool decks, patios, footpaths, driveways, parking spaces, pavements, etc. Available in Beige and Slate Grey.



GATOR DUST POLYMERIC STONE DUST
For natural stone joints 1/2" to 6". It's ideal for pedestrian patios, walkways, pool decks and many more scenarios. Available in Beige or Grey.



GATOR BLOCK XP XTRA POLYURETHANE ADHESIVE
XP XTRA performance polyurethane adhesive, low VOC is one of the strongest polyurethane adhesives on the market. It is specially formulated for overlays, pool copings, steps and wall caps, concrete pavers, wet cast, natural stones and retaining.



GATOR HYBRID LOW GLOSS SEALER
Gator Hybrid Seal is an acrylic copolymer used to seal concrete pavers. It penetrates deep into the concrete paver pores, thus reducing the oil and dirt penetration, as well as protecting them from the corrosion of de-icing salt.



GATOR EDGE FLEX AND RIGID
Made with 100% Polypropylene Copolymer giving this edging great strength and flexibility. Both the Rigid and Flex can be locked together with the "Twist & Lock" connection system. The Rigid could be transformed in a partial Flex by cutting the bridge support.



GATOR NAILS
Alliance Gator Nails are high quality 10" common models. Gator Nails are designed for use with all Gator Edge types.



EACO CHEM NMD80 NEW MASONRY DETERGENT
NMD 80 is a buffered acid-based new masonry cleaner designed for cleaning mortar smears off of new masonry structures. For use on a wide variety of substrates without harming the surface or color when used as directed. No scrubbing required. Available in 1 and 5 gallons.



GATOR CLEAN EFFLORESCENCE CLEANER
Gator Efflorescence Cleaner will remove any efflorescence stains trapped in the concrete pavers, wet cast products and natural stone pores. It makes the surface look clean and vibrant without discoloring or damaging the surface.



DISCOVER MORE PATTERNS
go to basalite.com

ARTISAN SLATE PREMIER

Pinwheel
80% 6x12 and 20% 6x6

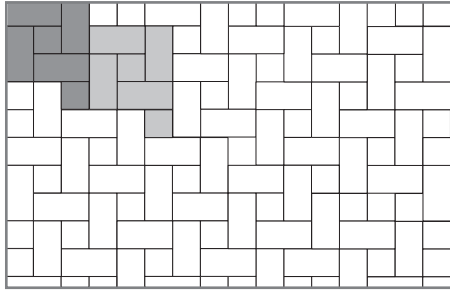

Blend
40% 6x12 and 60% 12x12

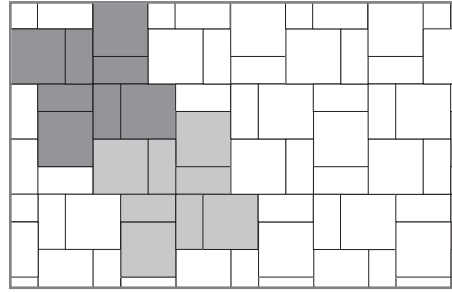

Plaid
45% 12x12, 45% 6x12 and 10% 6x6

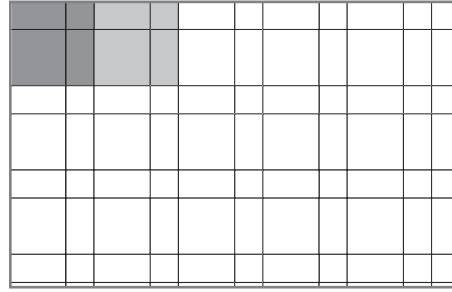

ARTISAN SLATE/ITALIAN RENAISSANCE/SAN FRANCISCO COBBLESTONE/COUNTRY COBBLE

Herringbone Flagstone
37.5% Mega, 37.5% Rectangle and 25% Square

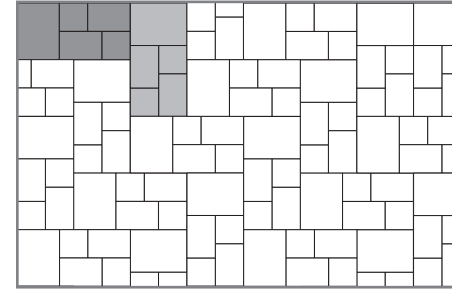

Random Two
30% Mega, 40% Rectangle and 30% Square

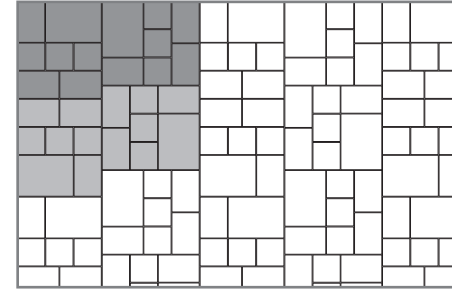

Mega Pattern Two
67% Mega and 33% Rectangle

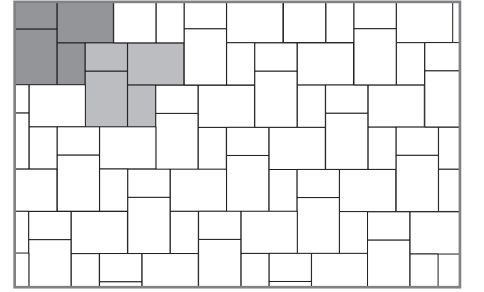

Herringbone Blend
66% 6x12 and 34% 6x6

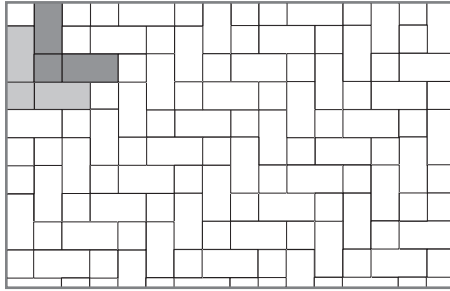

Premier
40% 12x12, 40% 6x12 and 20% 6x6

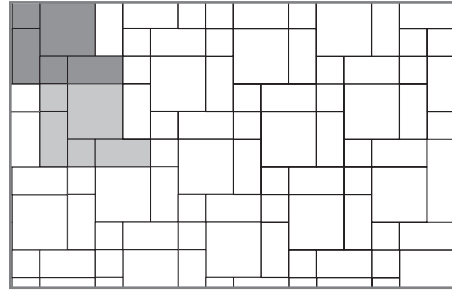

Diamond
50% 12x12, 25% 6x12 and 25% 6x6

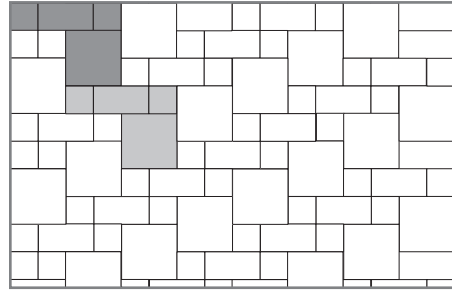

Two Way Parquet
67% Rectangle and 33% Square

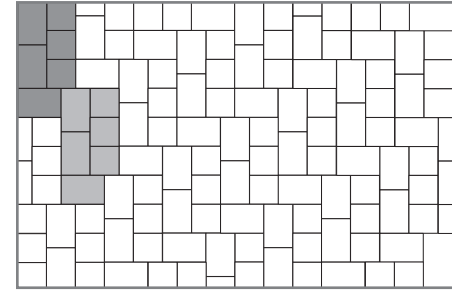

90 Degree Herringbone
100% Mega or 100% Rectangle

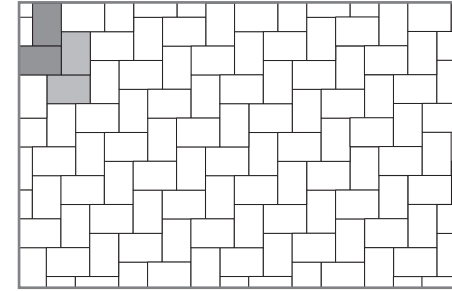

Soldier Course Border
100% 5x8 Border

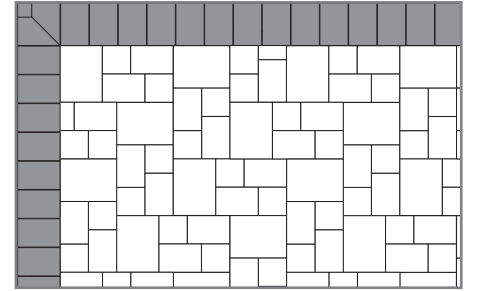

ARTISAN SLATE

4-Piece Wild
52% Double Mega, 26% Mega, 13% Rec. and 9% Square

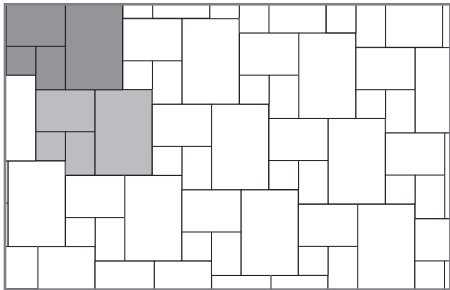

Double Mega Herringbone
40% Double Mega, 40% Mega and 20% Rectangle

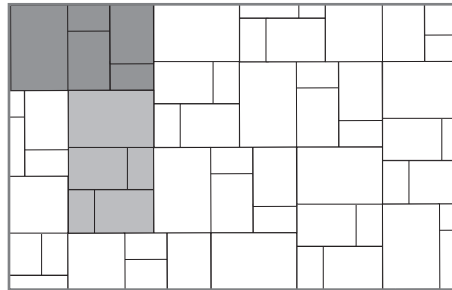

**PAVER
CALCULATOR**
Easily calculate how
many pavers you
need for your project.
Go to [basalite.com/
paver-estimator](http://basalite.com/paver-estimator)

PLANK PAVER

1/3 Offset Running Bond
100% 3x18

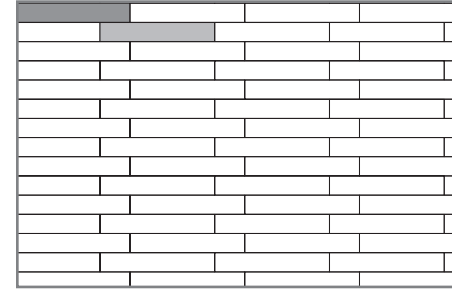

3x18 Herringbone Pattern
100% 3x18

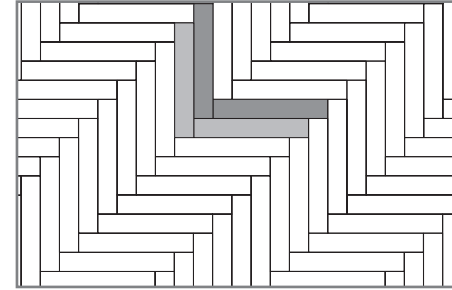

Basket Weave
100% 3x18

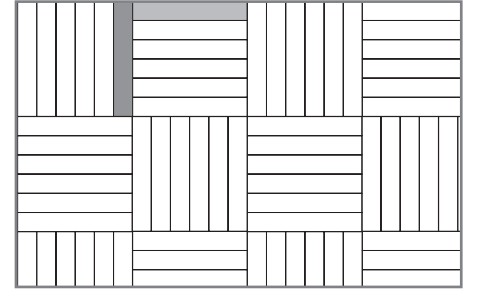

ARTISAN SLATE/COUNTRY COBBLE/ITALIAN RENAISSANCE

Interlace Pattern
75% Rectangle and 25% Square

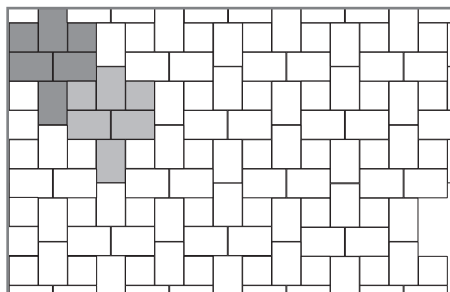

Random One
40% Mega, 20% Rectangle and 40% Square

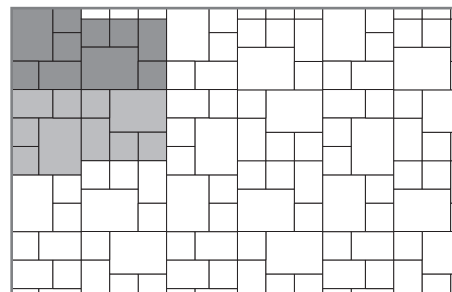

Random Cobble
60% Mega, 30% Rectangle, 10% Square

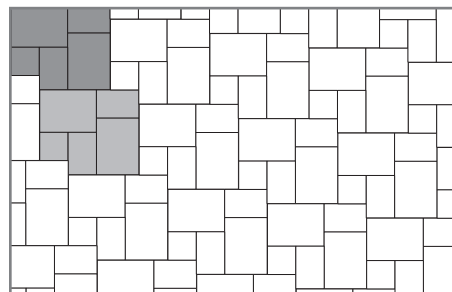

MISSION

90 Degree Herringbone Pattern
100% 4x8

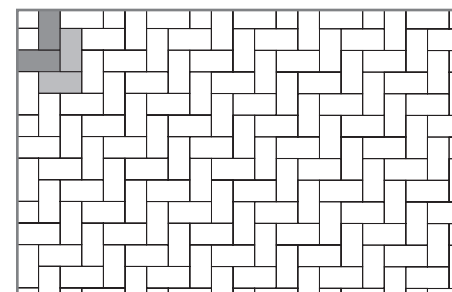

45 Degree Herringbone Pattern
100% 4x8

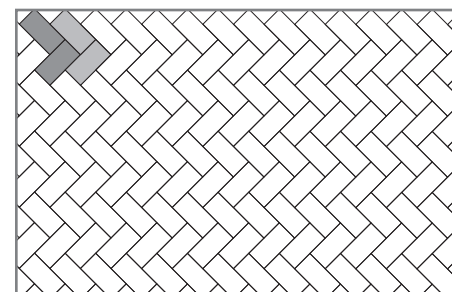

Double Basket Weave Pattern
100% 4x8

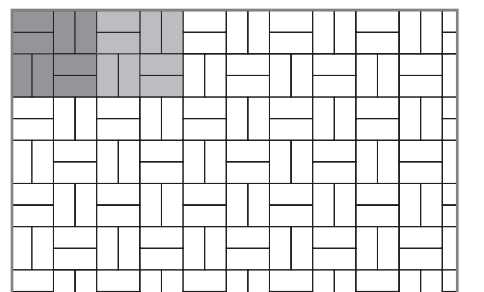

*The installation instructions and illustrations shown are a basic overview of paver and wall installation methods. Because installation methods vary per product, please refer to the Basalite product specific installation guide, the Standard ICPI installation method, ICPI.org, the NCMA-SRW installation guide, NCMA.org or visit basalite.com.

***TYPICAL PAVER INSTALLATION**

1. Excavate unsuitable, unstable or unconsolidated subgrade material and compact the area which has been cleared. Backfill and level with dense graded aggregate suitable for base material (typically 4"-6" for pedestrian and 6"-10" for driveway applications), or as otherwise directed by site engineer/architect/landscape architect.
2. Install edge restraint using concrete curb, concrete toe or edging.
3. Place bedding course of sharp, normal-weight screening or concrete sand to a uniform depth of approximately 1" leveled to grade.
4. Install Basalite Pavers hand tight with joints approximately 1/8". Where required, cut stones with an approved cutter to fit accurately.
5. Tamp pavers with mechanical vibrator, uniformly level, true to grade and free of movement. Textured pavers require a rubber pad for the vibrator to reduce scuffing.
6. Fill voids in joints by sweeping dry, fine, sharp sand over pavers.

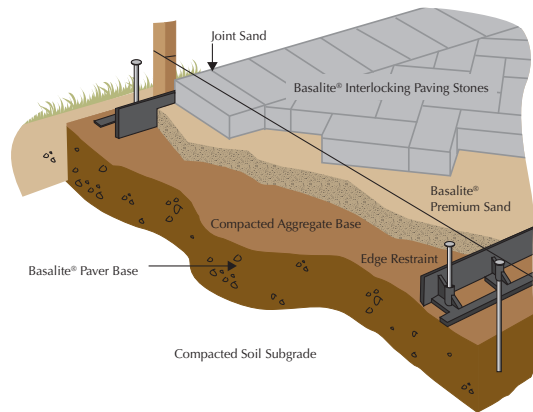

***PERMEABLE PAVER INSTALLATION**

1. Excavate unsuitable, unstable or unconsolidated subgrade material and compact the area in accordance to ICPI guidelines. Backfill and level Sub-base with No. 2 aggregate 2-1/2" crushed. Backfill and level base layer with No. 57 aggregate 3/4" crushed. The joint material and the foundation (paver bed, subbase, subgrade) must be permeable. 60mm thick pavers may be used in pedestrian applications.
2. Install edge restraint using concrete curb, concrete toe or edging.
3. Place bedding course of No. 8 aggregate 3/8" leveled to grade.
4. Install Pavers in closed assembly with spacer on stone for water drainage. Fill joints with gravel. Where required, cut stones with an approved cutter to fit accurately.
5. Tamp pavers with mechanical vibrator, uniformly level, true to grade and free of movement. Textured pavers require a rubber pad for the vibrator to reduce scuffing.
6. Fill voids in joints by sweeping dry ASTM No. 8, 89 or 9 stones.

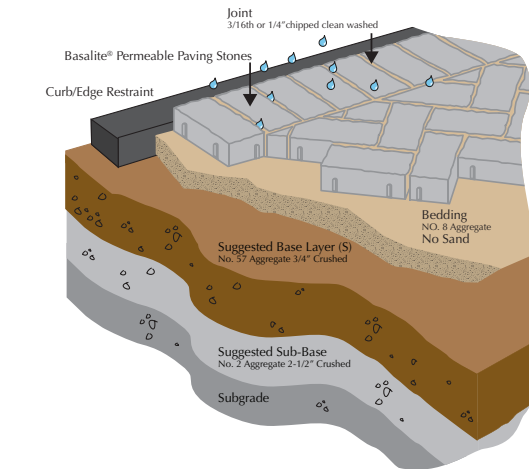

***STONEWALL II INSTALLATION**

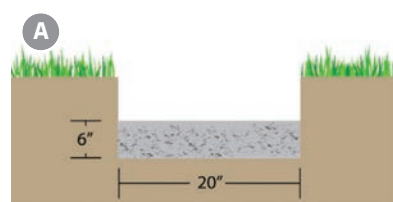

A. Prepare Base Leveling Pad
Excavate trench 20" wide and 12" deep along the length of wall, assuring depth provides proper unit embedment. On sloped sites, step up 6"

to change elevation. Place 6" of 3/4"-1/2" crushed aggregate in the trench. Level, then compact to 95% or greater of standard proctor.

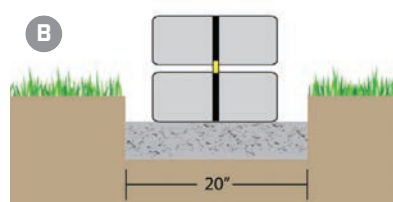

B. Set & Align Base Course
Starting at lowest elevation, ideally a corner, place and level the block using a string line and 2' level. Follow the suggested patterns as shown, or create your

own. Make sure the recess next to the center core is placed top up. Place alignment plugs into the center core following the guidelines below. Lay out the entire bottom course before proceeding to the next courses. Place perforated drain pipe onto leveling pad, behind base course (retaining wall) then backfill, 12" deep, to top of wall with crushed aggregate. Stack additional courses altering the pattern course to course.

*The installation instructions shown are a basic overview of wall installation methods. Because installation methods vary per product, please refer to the Basalite® product specific installation guide, the NCMA-SRW installation guide, NCMA.org or visit basalite.com. Brisa® Retaining Wall Systems can be used for gravity walls up to 3 feet high, including buried course, but excluding the cap. Taller walls can be built with the Retaining Wall System using geosynthetic reinforcement when designed by a qualified engineer. Height assumes level backfill and clean, compacted sand or gravel and no surcharge. Brisa® Freestanding Wall Systems can be used for walls up to 3 feet high, including buried course, but excluding the cap.

***TYPICAL RETAINING WALL INSTALLATION**

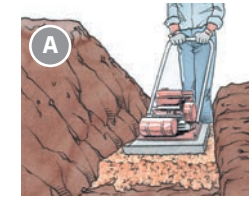

A. Prepare Base Leveling Pad
Excavate for the leveling pad. The trench should be at least 12 inches wider than the block you are installing and 6 inches deeper than the height of the block. Use a compactible base material of 3/4-inch minus (with fines) for the leveling pad. The pad must extend at least 6 inches in front of and behind the first course of

block, and be at least 6 inches deep after compaction. If the planned grade along the wall front will change elevation, the leveling pad may be stepped up in 6-inch increments to match the grade change. Start at the lowest level and work upward whenever possible. Compact the aggregate and make sure it's level front to back and side to side. Mist lightly with water before compaction.

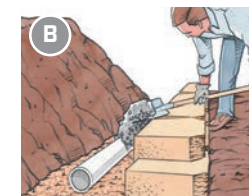

B. Base Course
Begin laying block at the lowest elevation of the wall. For quick-leveling, use the Torpedo™ base block with the hand-holds down, or you can remove the rear lip of the block by hitting from the back so it will lie flat on the leveling pad. Place the first block level, front to back and side to side; lay subsequent blocks in the same manner, flush against each other. Make sure they are in full contact with the leveling pad. If the wall is on an incline, don't slope the blocks; step them up so they remain consistently level. For multiple-piece products, use the largest unit, 18 inches wide, for the base course. Complete the base course before proceeding to the second course. A drainage pipe should be placed at rear base of first course.

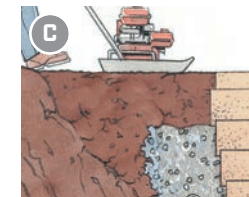

C. Stacking and Fill
Place the second course of blocks on top of the base course. Remember to keep the wall on bond by placing units in a staggered relationship to the course beneath. Pull each block forward as far as possible to ensure the correct setback. Backfill with drainage aggregate directly behind the block, adding 6 inches at a time, followed by proper compaction. Add soil fill behind the aggregate. Compact before the next course is laid. With the top units dry and clean, stack the caps on top of the final row and use a masonry construction adhesive.

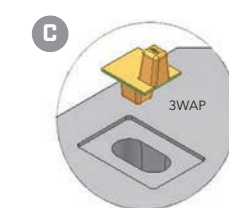

C. 3-Way Alignment Plug (3WAP)
After stacking the block course, place a 3WAP into the core of each unit, assuring that the flange on the plug rests within the recess adjacent to the core. Orient the plug to achieve your desired wall batter. Use the setback position for retaining walls to achieve a 7.3 degree batter, the vertical position for bench walls, and the reveal position to occasionally highlight a unit.

***BRISA® FREESTANDING WALL INSTALLATION**



A. Prepare Base Leveling Pad
Excavate a trench for the leveling pad to the lines and grades shown on the approved plans. The trench should be a minimum of 24 inches wide and 10 inches deep. Should the grade along the wall change elevation, step the trench up in equal block height increments so as to match the change of grade. Always start at

the lowest point and work upwards. Place a 3/4-inch minus crushed aggregate into the excavated trench; assure aggregate depth is at least 6 inches, and extends beyond the front and back of the block by a minimum of 6 inches. After placing the aggregate into the excavated trench, level the material and compact to 95% standard proctor.



B. Base Course
Place a level string line along the length of a wall and to the back top edge of the desired location of the blocks. Assure that the string is level and at the desired height of the first course of blocks. Begin stacking the blocks at the lowest point in the wall, work upwards by placing the Torpedo™ base block with the

hand-holds down to ensure proper contact with the leveling pad. As the blocks are placed, use a small level to assure that the blocks are level front to back and side to side. Utilize a 4-foot level to assure that a group of blocks are level side to side.

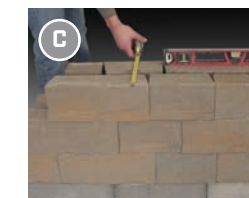

C. Stacking and Fill
Build the next course and glue to the base blocks. Work from the appropriate side of the pattern as you face the wall. Use 1/2-inch-diameter of glue 3 inches apart in the front half of the block. Build a separate wall on each side of the base unit. Maintain a consistent gap of roughly 1 inch between the parallel walls.

Continue to build one layer of the pattern on each side of the wall, maintaining a uniform distance between the two walls. Check horizontal and vertical levels of each wall. Periodically check the distance between the wall faces to ensure consistent spacing. Gaps will vary on curves. Flip blocks over on curves as needed. This reduces the need to cut blocks. Sweep all debris from the top course. Lay out all the caps onto the wall before gluing. Confirm the blocks are dry, then place a bead of masonry/concrete construction adhesive onto the top course of block, at the front and back of the block and along the entire length of the wall. Place the caps onto the adhesive and into the desired position.

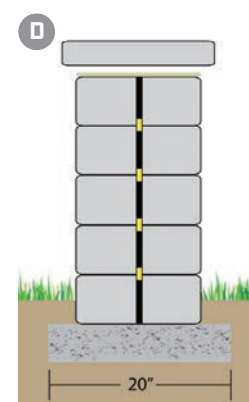

D. Capping the Wall
Adhere clean and dry cap blocks to the wall using silicon concrete construction adhesive. Place cap flush to the wall face or with an overhang.