





Premier Smooth in Bodega Dunes / 10

# BUILDING VALUES

For over 40 years, Basalite® has worked on growing our business by building relationships. We have created strong bonds with our dealers, masons, architects, engineers and licensed contractors. From working together with the common purpose of installing the finest hardscape products available, we have seen our products placed in settings that range from practical to magical. At Basalite®, we are committed to being the best in the industry. Our focus now, just as it was when we opened our doors all those years ago, is on service, quality and innovation. Those are the values that have made us the industry leader we are today and the same principles that will guide us far into the future.

Cover image: Premier Slate in Torino / 8



Lakeland Wall in Santa Fe / 30  
Italian Renaissance in Custom Color / 12



Premier Slab in Mt. Whitney / 6



Stonewall II in Grey Blend / 24  
Premier Smooth in Torino / 10

<b>INTRODUCTION</b>	
Inspiring Outdoor Spaces	2
<b>PAVERS</b>	
Premier Slab	6
Premier Slate	8
Premier Smooth	10
Italian Renaissance	12
Plank Paver	14
Interstate® Brick Clay Pavers	16
Mission	18
Wood Grain	19
<b>PERMEABLE PAVERS</b>	
Spec Pave	20
Permeable Plank	21
TurfStone	22
<b>STEPPING STONES</b>	23
<b>RETAINING &amp; LANDSCAPE WALLS</b>	
Stonewall® II	24
Stonewall® II Column Kit	26
Hudson™ Stone	27
Garden Stack	28
Windsor Stone®	29
Lakeland™	30
Natural Impressions	31
Diamond® 3-Way	32
Diamond® Straight Face	33
Diamond® 10DS	34
GravityStone® Encore	35
Veteran Pro	36
Geowall™ Pro	37
Geowall™ Max & Max II	38
Geowall™ Plus	39
<b>OUTDOOR LIVING KITS</b>	
Necessaries™ The Kitchen	40
Necessaries™ Cabinet Kits	42
Necessaries™ Outdoor Fireplaces	46
Fire Pit Kits	48
Necessaries™ Water Features	50
Necessaries™ Pillars & Seat Walls	51
<b>INSTALLATION INSTRUCTIONS</b>	
Typical Paver Installation	52
Permeable Paver Installation	52
Typical Retaining Wall Installation	53
<b>ACCESSORIES</b>	
Edgers & Accessories	54
<b>PACKAGED PRODUCTS</b>	56
<b>BUILDING BLOCKS</b>	62
<b>MASONRY &amp; UTILITY PRODUCTS</b>	64

# GREAT HARDSCAPES START HERE



Necessaries™ The Kitchen™ in Santa Fe, Black Pearl Granite / 40

Basalite® sets the standard for hardscapes with our extensive collection of quality pavers, walls and outdoor living kits. Our large selection of styles, shapes, colors and textures allows you to transform patios, driveways, outdoor kitchens, pool areas and walkways into beautiful outdoor living areas.

Get inspiration for your next outdoor project with these designs showcasing real-life projects. Share your photos with us on Instagram, Pinterest, X, Facebook or LinkedIn.



Premier Slab in Oceanside / 6

\*Outdoor Pizza Oven and Green Egg not sold through Basalite.



Premier Slate in Positano with Sealer / 8



Italian Renaissance Pavers in Venice / 12  
Stonewall II in Tan Blend / 24



Grand Fireplace Kit / 46  
in Santa Fe\*

Premier Smooth in Oceanside / 10

\*Shown with optional wood box and hearth.

# PREMIER SLAB



## DESIGN FEATURE

Use as stepping stones or combine Slabs to create continuous surfaces such as patios or pathways.

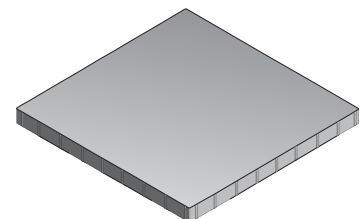

24x24

### Running Bond Pattern 100% Premier Slab

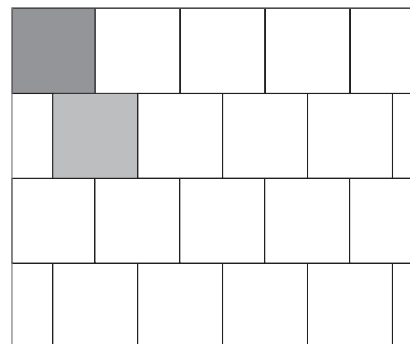

Name	Metric Units	U.S. Customary Units	Weight	Units /Pallet	Sq. Ft. /Pallet
24x24	594mm W x 594mm L x 60mm H	23.5" W x 23.5" L x 2.375" H	106 lbs	32	123

For design consideration add 1.5mm or .06" to the W and L dimensions to allow for the spacers.

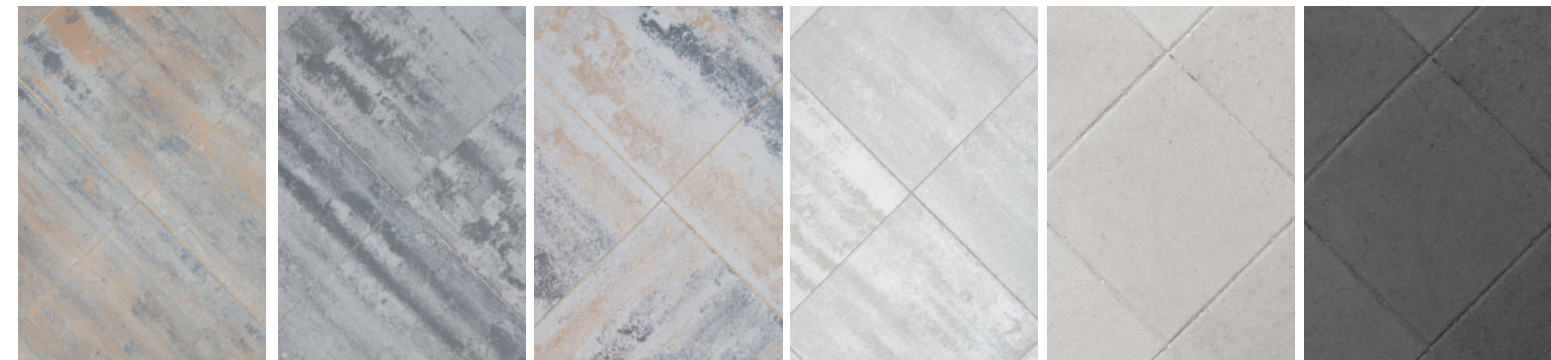

POSITANO

TORINO

BODEGA DUNES\*

OCEANSIDE\*

MT. WHITNEY

TRUCKEE

\*SPECIAL ORDER ONLY

Printed colors shown in this brochure may vary from actual product colors. We recommend selecting colors from actual product samples.

# PREMIER SLATE



Torino

PATTERNS / visit basalite.com



**DESIGN IDEA**

Create visual drama by using contrasting colors.



Positano with Charcoal Border



Positano

**Sold as a Basalite Combo Pallet Only**

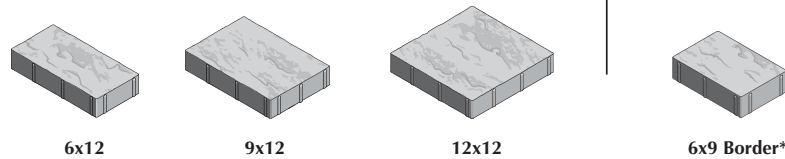

**Pallet Configuration**

One pallet layer = 4 (6x12) - 4 (12x12) - 4 (12x18)  
9 layers per pallet

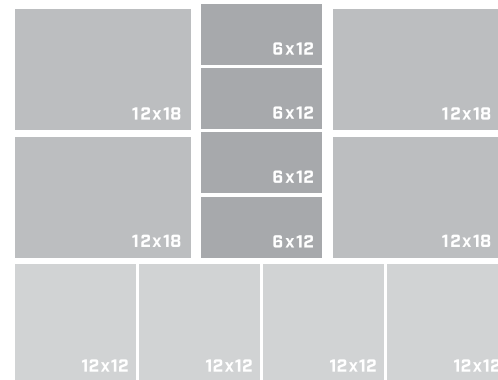

Name	Metric Units	U.S. Customary Units	Weight	Units/Pallet	Sq. Ft. /Pallet
6x12	148mm W x 298mm L x 60mm H	5.83" W x 11.73" L x 2.375" H	3,378 lbs	96 (6x12), 64 (9x12), 32 (12x12) for a full pallet qty. of 192	121.9
9x12	223mm W x 298mm L x 60mm H	8.78" W x 11.73" L x 2.375" H			
12x12	298mm W x 298mm L x 60mm H	11.73" W x 11.73" L x 2.375" H			
6x9 Border*	148mm W x 223mm L x 60mm H	5.83" W x 8.78" L x 2.375" H	9.4 lbs	280	100



POSITANO

TORINO

BODEGA DUNES\*

MIDNIGHT TERRACE\*

\*SPECIAL ORDER ONLY

OCEANSIDE\*

CHARCOAL  
6 x 9 Border

For design consideration add 1.5mm or .06" to the W and L dimensions to allow for the spacers. \*6x9 is palletized and sold separately.

Printed colors shown in this brochure may vary from actual product colors. We recommend selecting colors from actual product samples.

# PREMIER SMOOTH



Oceanside

**PATTERNS** / visit [basalite.com](http://basalite.com)



**DESIGN IDEA**  
Include complementary walls to complete your dream space.



Torino



Oceanside with Charcoal Border

Sold as a Basalite Combo Pallet Only

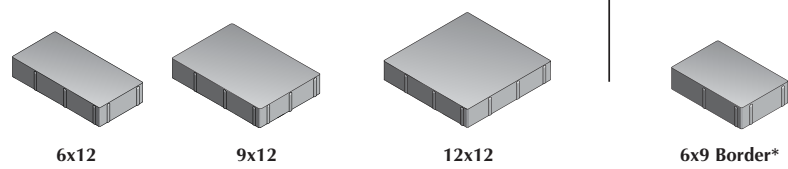

6x12

9x12

12x12

6x9 Border\*

### Pallet Configuration

One pallet layer = 4 (6x12) - 4 (12x12) - 4 (12x18)  
9 layers per pallet

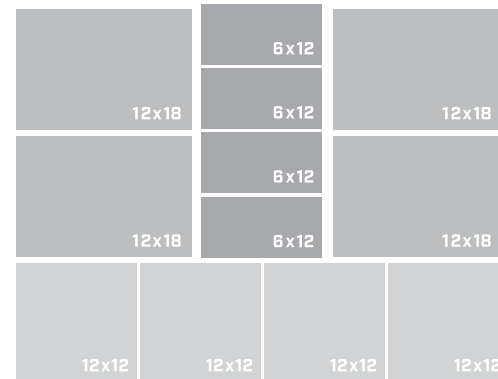

Name	Metric Units	U.S. Customary Units	Weight	Units/Pallet	Sq. Ft. /Pallet
6x12	148mm W x 298mm L x 60mm H	5.83" W x 11.73" L x 2.375" H	3,378 lbs	96 (6x12), 64 (9x12), 32 (12x12) for a full pallet qty. of 192	121.9
9x12	223mm W x 298mm L x 60mm H	8.78" W x 11.73" L x 2.375" H			
12x12	298mm W x 298mm L x 60mm H	11.73" W x 11.73" L x 2.375" H			
6x9 Border*	148mm W x 223mm L x 60mm H	5.83" W x 8.78" L x 2.375" H	9.4 lbs	280	100



POSITANO

TORINO

BODEGA DUNES\*

MIDNIGHT  
TERRACE\*

\*SPECIAL ORDER ONLY

OCEANSIDE\*

CHARCOAL  
6 x 9 Border

Printed colors shown in this brochure may vary from actual product colors. We recommend selecting colors from actual product samples.

<sup>10</sup> For design consideration add 1.5mm or .06" to the W and L dimensions to allow for the spacers. \*6x9 is palletized and sold separately.

# ITALIAN RENAISSANCE



Venice

PATTERNS / visit [basalite.com](http://basalite.com)



**DESIGN IDEA**

Gain dramatic appeal by combining texture and color that complement your home's exterior.



Pacifica

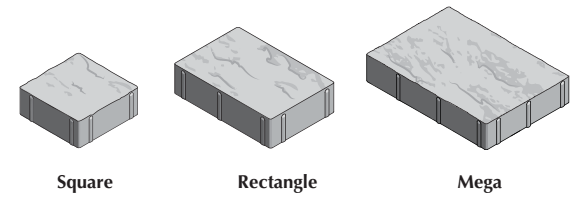

Square

Rectangle

Mega

Name	Metric Units	U.S. Customary Units	Weight	Units/Pallet	Sq. Ft./Pallet
Square	138mm W x 138mm L x 60mm H	5.43" W x 5.43" L x 2.375" H	6 lbs	512	107
Rectangle	138mm W x 208mm L x 60mm H	5.43" W x 8.19" L x 2.375" H	8 lbs	384	121
Mega	208mm W x 278mm L x 60mm H	8.19" W x 10.94" L x 2.375" H	19 lbs	160	102

For design consideration add 1.5mm or .06" to the W and L dimensions to allow for the spacers.



VENICE



PACIFICA

Printed colors shown in this brochure may vary from actual product colors. We recommend selecting colors from actual product samples.



# PLANK PAVER



## DESIGN FEATURE

Our 100mm Plank Paver is suitable for light-duty and commercial vehicular projects.

PATTERNS / [visit.basalite.com](http://visit.basalite.com)

Custom blend

Custom blend

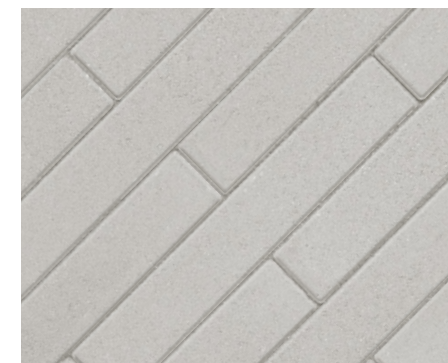
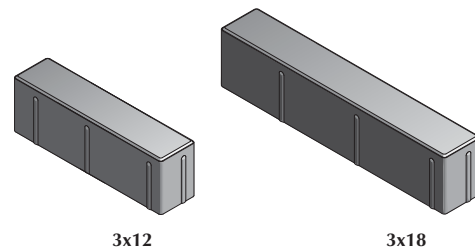

MT. WHITNEY



PESCADERO

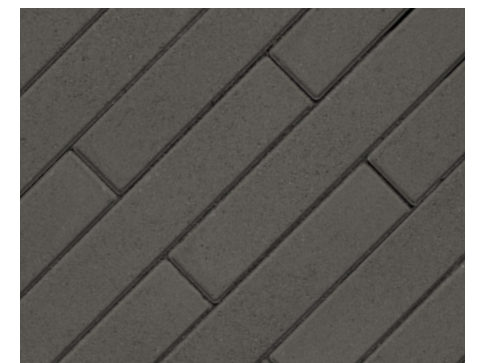

TRUCKEE

Printed colors shown in this brochure may vary from actual product colors. We recommend selecting colors from actual product samples.

Name	Metric Units	U.S. Customary Units	Weight	Units/Pallet	Sq. Ft./Pallet
3x12	73mm W x 296mm L x 100mm H	2.87" W x 11.64" L x 3.94" H	11 lbs	280	67.8
3x18	73mm W x 448mm L x 100mm H	2.87" W x 17.64" L x 3.94" H	16 lbs	140	50.9

For design consideration add 1.5mm or .06" to the W and L dimensions to allow for the spacers.

# CLAY PAVERS / WIRE CUT

CLAY PAVERS / WIRE CUT



Copperstone

**PATTERNS** / visit [basalite.com](http://basalite.com)



## DESIGN IDEA

Clay pavers bring an unmatched aesthetic appeal to any project.

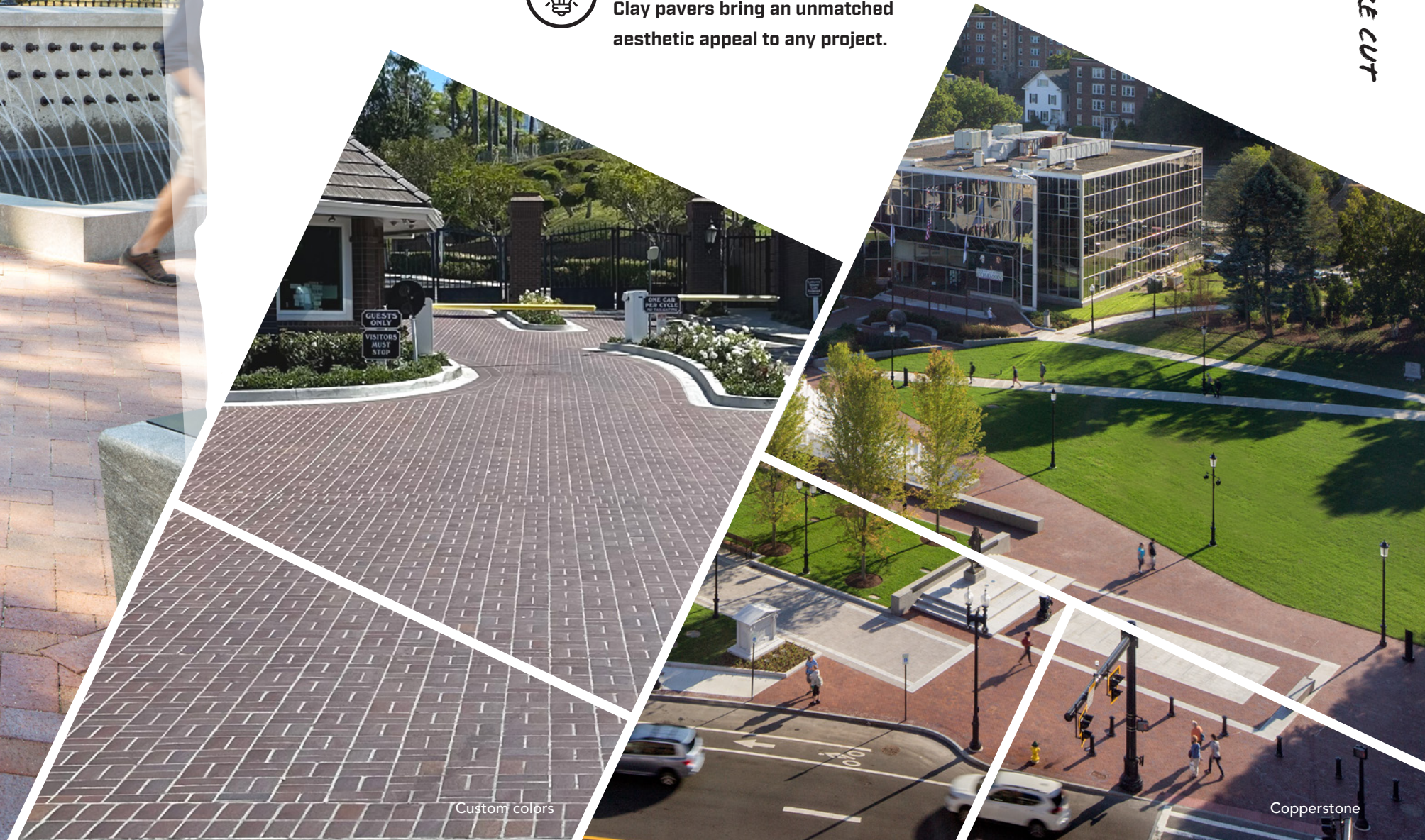

Custom colors

Copperstone

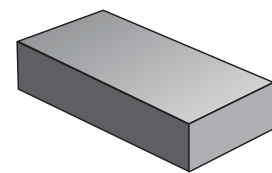

4x8 True/Tumbled

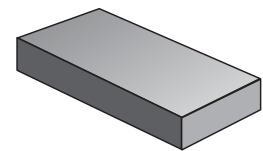

4x8 Split

Name	Metric Units	U.S. Customary Units	Weight	Bricks/Cube	Weight/Cube	Sq. Ft./Cube
4x8 True	102mm W x 203mm L x 57mm H	4" W x 8" L x 2.25" H	5.4 lbs	500	2730 lbs	111
4x8 True Tumbled	102mm W x 203mm L x 57mm H	4" W x 8" L x 2.25" H	5.4 lbs	500	2730 lbs	111
4x8 True Split	102mm W x 203mm L x 32mm H	4" W x 8" L x 1.25" H	2.9 lbs	664	1956 lbs	147.5



**PLATINUM** **COPPERSTONE** **BAJA BROWN** **TERRA COTTA** **MOUNTAIN RED** **IRONSTONE** **MIDNIGHT BLACK**

Contact your sales rep or local dealer for additional colors.

Printed colors shown in this brochure may vary from actual product colors. We recommend selecting colors from actual product samples.

# MISSION



Lamp Black



**LAMP BLACK**  
Special Order Only

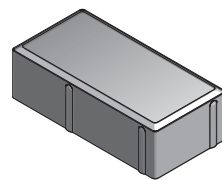

4x8x60

Name	Metric Units	U.S. Customary Units	Weight	Units/Pallet	Sq. Ft./Pallet
4x8	98mm W x 198mm L x 60mm H	3.86" W x 7.795" L x 2.375" H	5.8 lbs	432	92.45

Available by special order only. For design consideration add 1.5mm or .06" to the W and L dimensions to allow for the spacers.

# WOOD GRAIN PAVER



Driftwood



**DRIFTWOOD**

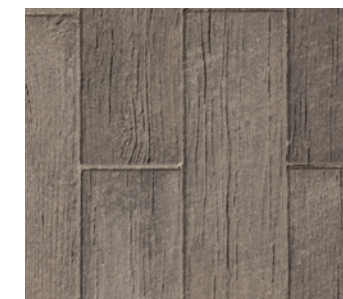

**TEAKWOOD**  
Special Order Only



**REDWOOD**  
Special Order Only

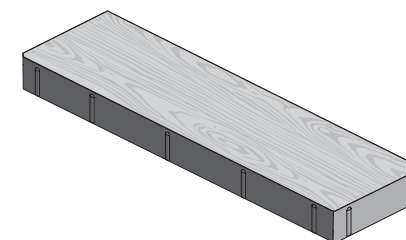

Wood Grain Paver

Name	Metric Units	U.S. Customary Units	Weight	Units/Pallet	Sq. Ft./Pallet
Wood Grain	148mm W x 448mm L x 60mm H	5.83" W x 17.64" L x 2.375" H	19 lbs	112	81.3

For design consideration add 1.5mm or .06" to the W and L dimensions to allow for the spacers.

# SPEC PAVE



Custom color blend

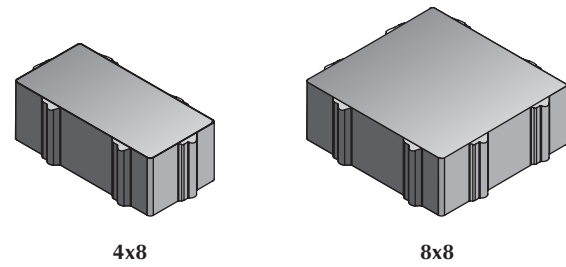

Name	Metric Units	U.S. Customary Units	Weight	Units/Pallet	Sq. Ft./Pallet
4x8	98mm W x 196mm L x 80mm H	3.483" W x 7.342" L x 3.125" H	6.5 lbs	300	62
8x8	196mm W x 196mm L x 80mm H	7.342" W x 7.342" L x 3.125" H	13.9 lbs	150	62

For design consideration add 9.5mm or .375" to the W and L dimensions to allow for the spacers.



LAMP BLACK



NATURAL  
Special Order Only

# PERMEABLE PLANK



Custom color blend

AVAILABLE BY SPECIAL ORDER IN THE COLOR TRUCKEE ONLY

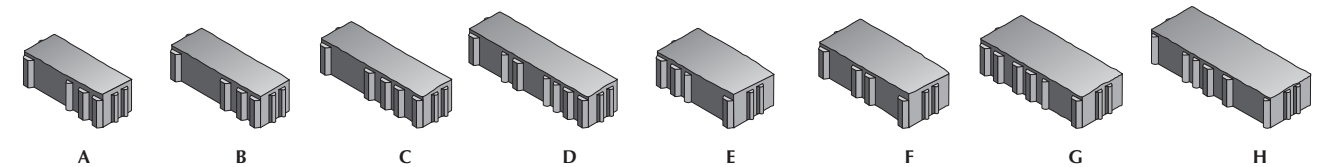

Name	Metric Units	U.S. Customary Units	Weight	Units/Pallet	Sq. Ft./Pallet
A	84mm W x 237mm L x 100mm H	3.31" W x 9.33" L x 3.93" H	8 lbs	30	Sold in mixed pallet only. 86.4
B	84mm W x 277mm L x 100mm H	3.31" W x 10.91" L x 3.93" H	9.3 lbs	30	
C	84mm W x 317mm L x 100mm H	3.31" W x 12.48" L x 3.93" H	10.6 lbs	30	
D	84mm W x 357mm L x 100mm H	3.31" W x 14.06" L x 3.93" H	12 lbs	30	
E	114mm W x 237mm L x 100mm H	4.48" W x 9.33" L x 3.93" H	10.8 lbs	30	
F	114mm W x 277mm L x 100mm H	4.48" W x 10.91" L x 3.93" H	12.6 lbs	30	
G	114mm W x 317mm L x 100mm H	4.48" W x 12.48" L x 3.93" H	14.4 lbs	30	
H	114mm W x 357mm L x 100mm H	4.48" W x 14.06" L x 3.93" H	16.2 lbs	30	

For design consideration add 9.5mm or .375" to the W and L dimensions to allow for the spacers.

# TURFSTONE

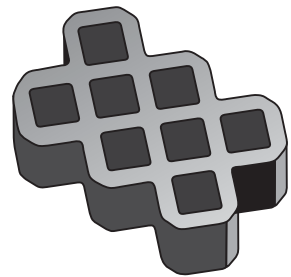
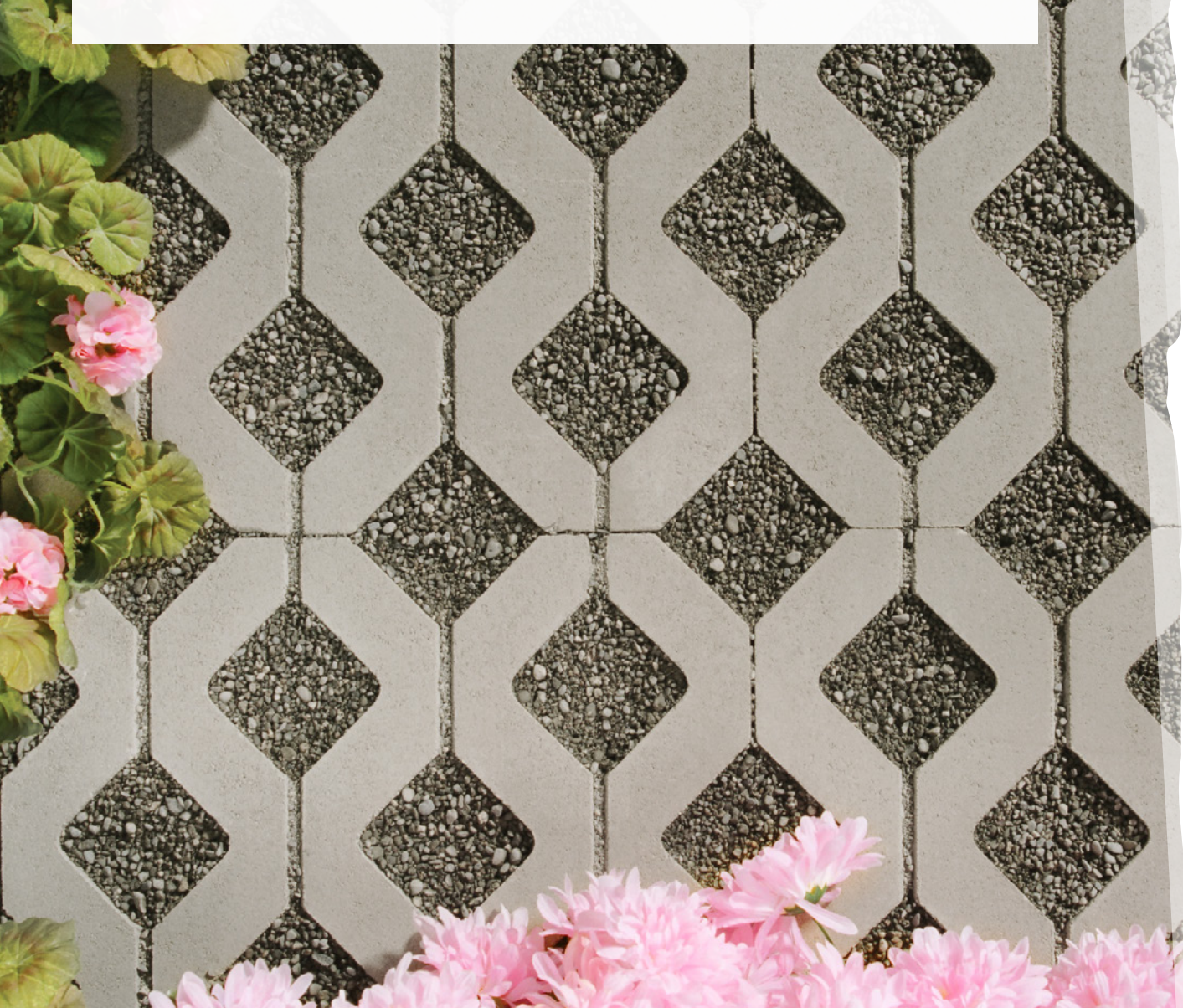

Name	Metric Units	U.S. Customary Units	Weight	Units/Pallet	Sq. Ft./Pallet
Turfstone	396mm W x 597mm L x 80mm H	15.6" W x 23.5" L x 3.125" H	73 lbs	20	45

Conforms to ASTM C1319 – See Tech Spec documentation for applications and design considerations. Grey only.

# STEPPING STONES



NATURAL



RED



EXPOSED AGGREGATE

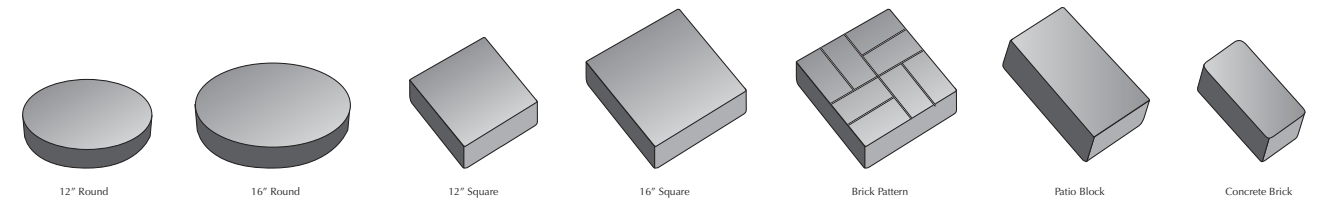

Name	Metric Units	U.S. Customary Units	Weight	Units/Pallet
12" Round (Red or Natural)	305mm D x 51mm H	12" D x 2" H	15 lbs	120
16" Round (Natural or Exposed Aggregate)	406mm D x 51mm H	16" D x 2" H	31 lbs	72
12" Square (Red or Natural)	305mm W x 305mm L x 57mm H	12" W x 12" L x 2.25" H	25 lbs	144
16" Square (Natural or Exposed Aggregate)	406mm W x 406mm L x 51mm H	16" W x 16" L x 2" H	38 lbs	90
16" Brick Pattern (Red)	406mm W x 406mm L x 51mm H	16" W x 16" L x 2" H	38 lbs	90
Patio Block (Red or Natural)	203mm W x 406mm L x 51mm H	8" W x 16" L x 2" H	12 lbs	240
Concrete Brick (Red or Natural)	102mm W x 203mm L x 57mm H	4" W x 8" L x 2.25" H	5 lbs	720

# STONEWALL® II WALL SYSTEM



**DESIGN IDEA**

Stonewall® can be built as a freestanding or retaining wall.



Tan Blend



Grey Blend



Custom Blend

SOLD IN FULL RANDOM MIXED PALLET QUANTITIES ONLY - 33 SQ. FT. /PALLET

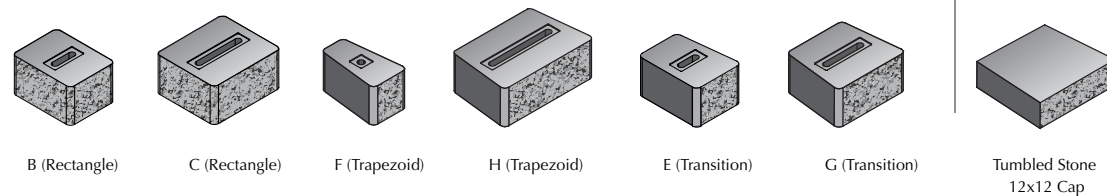

Name	Metric Units	U.S. Customary Units	Weight	Units/Pallet	Sq. Ft./Pallet
B (Rectangle)	203mm W x 267mm L x 153mm H	10.5" W x 8" L x 6" H	34 lbs	Mixed sizes. Sold in pallet quantities only.	33
C (Rectangle)	305mm W x 267mm L x 153mm H	10.5" W x 12" L x 6" H	50 lbs		
F (Trapezoid)	153/102mm W x 267mm L x 153mm H	10.5" W x 6/4" L x 6" H	21 lbs		
H (Trapezoid)	406/356mm W x 267mm L x 153mm H	10.5" W x 16/14" L x 6" H	64 lbs		
E (Transition)	203/178mm W x 267mm L x 153mm H	10.5" W x 8/7" L x 6" H	32 lbs		
G (Transition)	305/279mm W x 267mm L x 153mm H	10.5" W x 12/11" L x 6" H	49 lbs		
Tumbled Stone 12x12 Cap	305mm W x 305mm L x 76mm H	12" W x 12" L x 3" H	24 lbs	120	30



TAN BLEND



GREY BLEND

Printed colors shown in this brochure may vary from actual product colors. We recommend selecting colors from actual product samples.

# STONEWALL® II COLUMN KIT

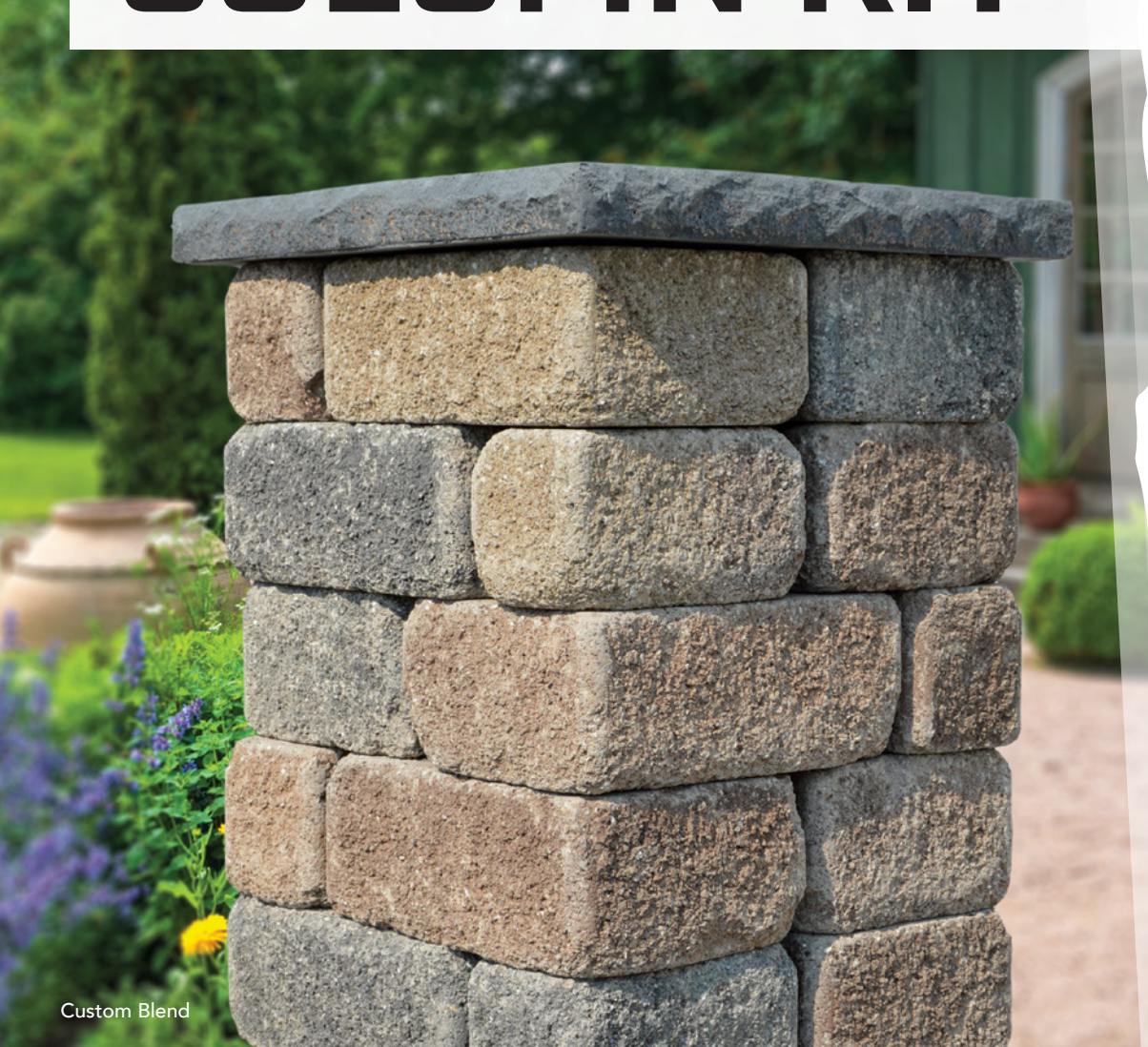

Custom Blend



**TAN BLEND**  
Special Order Only



**GREY BLEND**  
Special Order Only

# HUDSON™ STONE



Custom Color



**GREY**



**ROSE CHARCOAL**

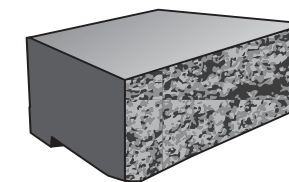
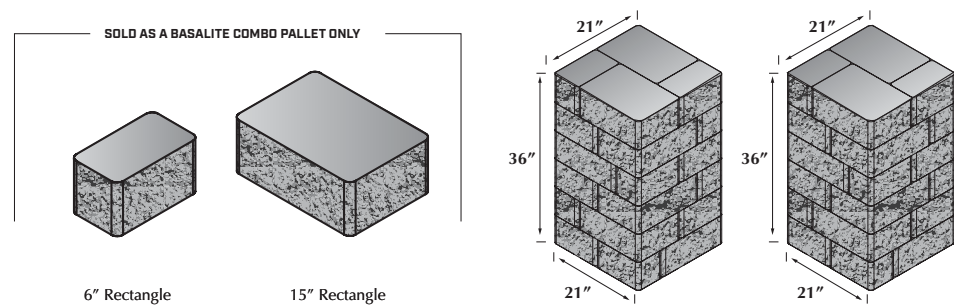

Hudson™ Stone

Name	Metric Units	U.S. Customary Units	Weight	Units/Pallet
6" Rectangle	267mm W x 153mm L x 153mm H	6" W x 10.5" L x 6" H	28 lbs	24 (6" Rectangle) and 24 (15" Rectangle) for a full pallet quantity of 48 pieces
15" Rectangle	381mm W x 267mm L x 153mm H	15" W x 10.5" L x 6" H	70 lbs	

Available by special order only. Each finished column is 21" x 21" square. Kit makes two, 3' tall columns. Cap sold separately.

Name	Metric Units	U.S. Customary Units	Weight	Units/Pallet
Hudson™ Stone	216mm W x 102mm L x 140mm H	8" W x 5" L x 4" H	12 lbs	216

# GARDEN STACK



Tan



TAN



GREY

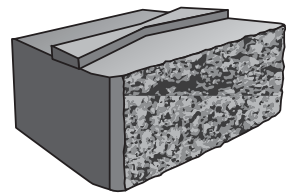

Garden Stack

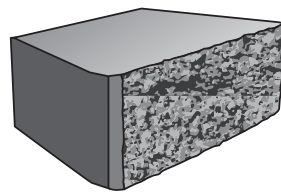

Cap

Name	Metric Units	U.S. Customary Units	Weight	Units/Pallet
Garden Stack	200mm W x 150mm L x 102mm H	7.87" W x 7.87" L x 4" H	15 lbs	180
Cap	200mm W x 150mm L x 102mm H	7.87" W x 7.87" L x 4" H	15 lbs	180

# WINDSOR STONE®



Tan



TAN



GREY



ROSE CHARCOAL

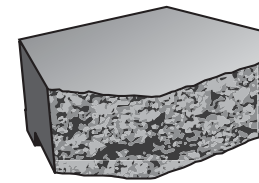

Windsor Stone

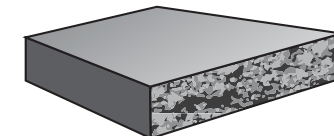

Cap

Name	Metric Units	U.S. Customary Units	Weight	Units/Pallet
Windsor Stone®	295mm W x 178mm L x 102mm H	11.625" W x 7" L x 4" H	24 lbs	120
Windsor Cap	305/229mm W x 190.5mm L x 60mm H	12/9" W x 7.5" L x 2.375" H	15 lbs	120



# LAKELAND™



Santa Fe



SANTA FE



DESERT



BLUESTONE

# NATURAL IMPRESSIONS



Flagstone™



FLAGSTONE™  
Tan Charcoal



ASHLARSTONE™  
Tan Charcoal

SOLD IN MIXED PALLET QUANTITIES ONLY. 26.4 SQ. FT. /PALLET

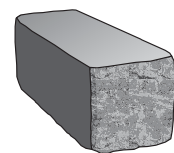

Lakeland™ II Small

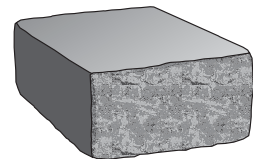

Lakeland™ II Medium

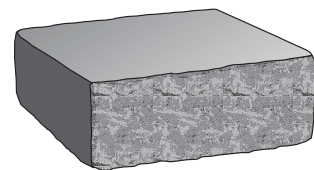

Lakeland™ Standard

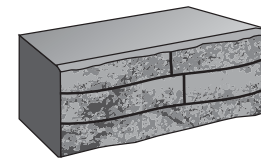

Flagstone™

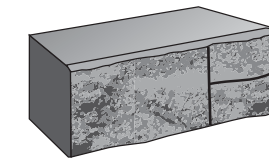

Ashlarstone™

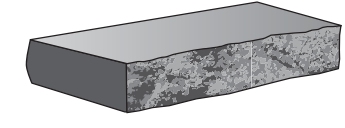

Cap

Name	Metric Units	U.S. Customary Units	Weight	Units/Pallet
Small	102mm W x 203mm L x 102mm H	4" W x 8" L x 4" H	10 lbs	80 units of each size
Medium	203mm W x 203mm L x 102mm H	8" W x 8" L x 4" H	20 lbs	
Standard	305mm W x 203mm L x 102mm H	12" W x 8" L x 4" H	31 lbs	80

Name	Metric Units	U.S. Customary Units	Weight	Units/Pallet
Flagstone™	305mm W x 181mm L x 102mm H	12" W x 7.125" L x 4" H	22 lbs	120
Ashlarstone™	305mm W x 181mm L x 102mm H	12" W x 7.125" L x 4" H	22 lbs	120
Cap	305mm W x 203mm L x 51mm H	12" W x 8" L x 2" H	14 lbs	120

# DIAMOND® 3-WAY

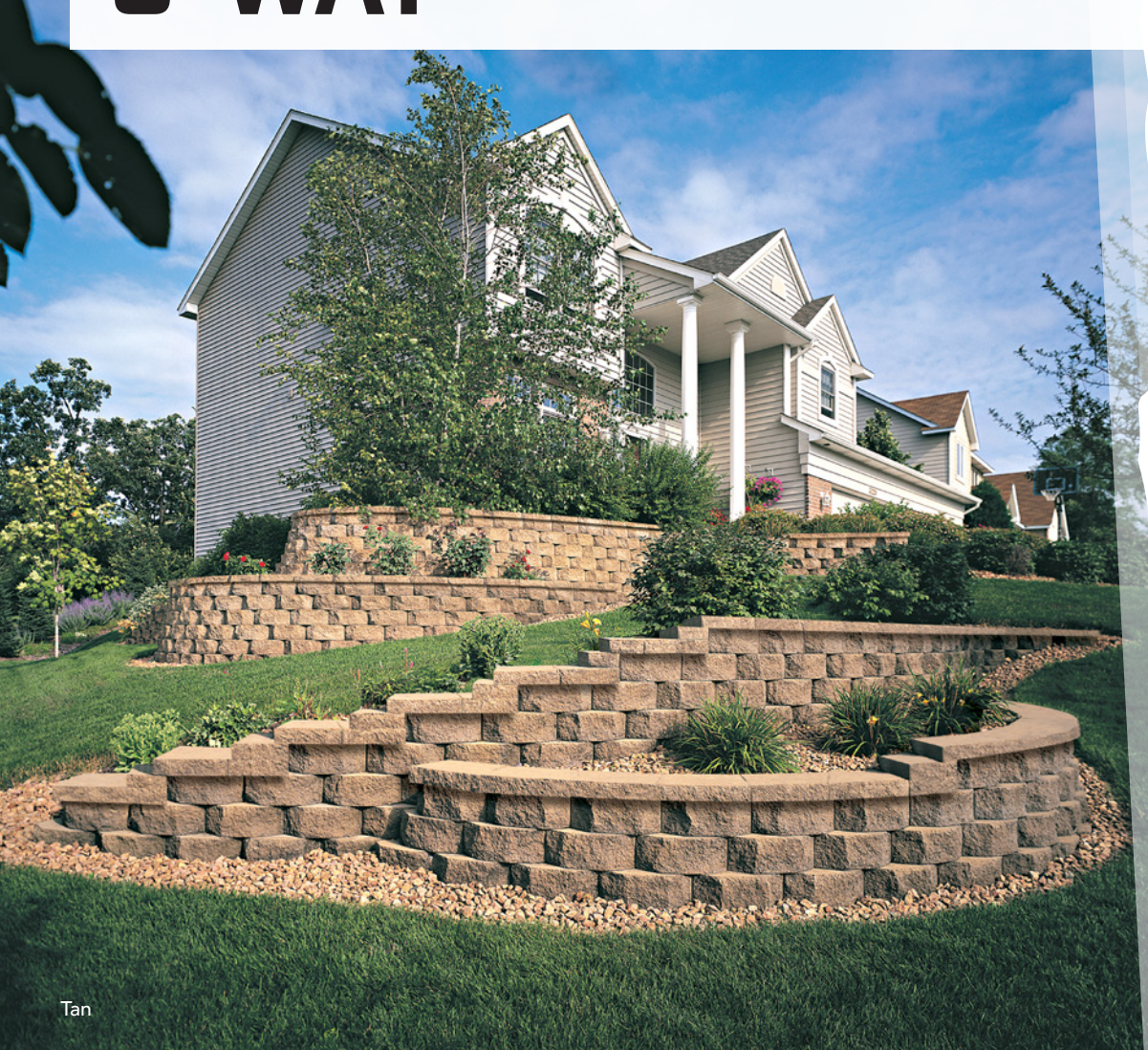

Tan



TAN



GREY



ROSE CHARCOAL

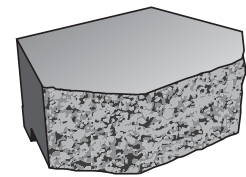

Diamond® 3-Way

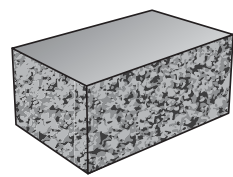

Corner

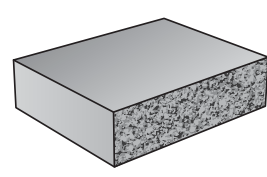

Step

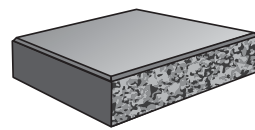

Estate Cap

Name	Metric Units	U.S. Customary Units	Weight	Units/Pallet
Diamond 3-Way	403mm W x 279mm L x 152mm H	15.861" W x 11" L x 6" H	55 lbs	45
Corner	406mm W x 203mm L x 152mm H	16" W x 8" L x 6" H	63 lbs	60
Step	406mm W x 406mm L x 152mm H	16" W x 16" L x 6" H	126 lbs	24
Estate Cap	412mm W x 305mm L x 76mm H	16.22" W x 12" L x 3" H	39 lbs	63

# DIAMOND® STRAIGHT FACE



Grey



TAN



GREY

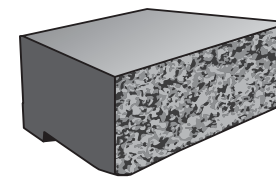

Diamond® Straight

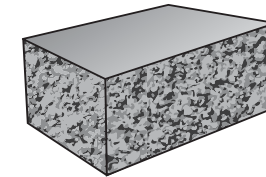

Corner

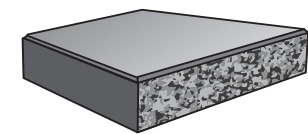

Estate Cap

Name	Metric Units	U.S. Customary Units	Weight	Units/Pallet
Diamond Straight	438mm W x 279mm L x 152mm H	17.25" W x 11" L x 6" H	55 lbs	45
Corner	406mm W x 203mm L x 152mm H	16" W x 8" L x 6" H	63 lbs	60
Estate Cap	412mm W x 305mm L x 76mm H	16.22" W x 12" L x 3" H	39 lbs	63

# DIAMOND® 10DS



Tan



TAN



GREY



GREY CHARCOAL



ROSE CHARCOAL

# GRAVITYSTONE® ENCORE



Special order Tan



TAN  
Special Order



GREY

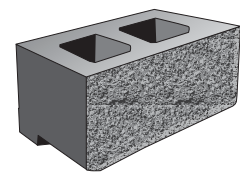

Diamond® 10DS

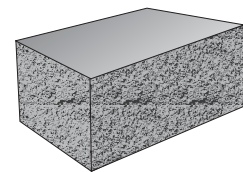

Corner

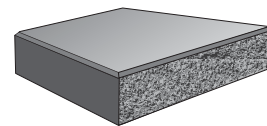

Estate Cap

SOLD IN MIXED PALLET QUANTITIES ONLY.

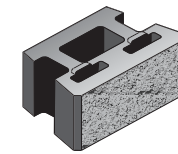

Straight Face

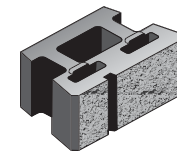

Ashlar Face

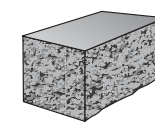

Corner

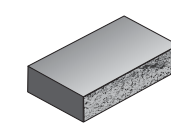

4" Straight Side Cap

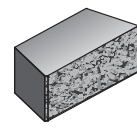

8" Straight Face  
Angled Side Cap

Name	Metric Units	U.S. Customary Units	Weight	Units/Pallet
Diamond 10DS	438mm W x 254mm L x 152mm H	17.248" W x 10" L x 6" H	55 lbs	45
Corner	406mm W x 203mm L x 152mm H	16" W x 8" L x 6" H	63 lbs	60
Estate Cap	412mm W x 305mm L x 76mm H	16.22" W x 12" L x 3" H	39 lbs	63

Name	Metric Units	U.S. Customary Units	Weight	Units/Pallet
Straight Face	454mm W x 279mm L x 203mm H	17.875" W x 11" L x 8" H	70 lbs	18 units of each face
Ashlar Face	454mm W x 279mm L x 203mm H	17.875" W x 11" L x 8" H	70 lbs	
Corner	457mm W x 229mm L x 203mm H	18" W x 9" L x 8" H	90 lbs	40
4" Straight Side Cap*	457mm W x 279mm L x 102mm H	18" W x 11" L x 4" H	60 lbs	64
8" Straight Face Angled Side Cap	457/356mm W x 267mm L x 203mm H	18/14" W x 10.5" L x 8" H	119 lbs	32

# VETERAN PRO



TAN



GREY

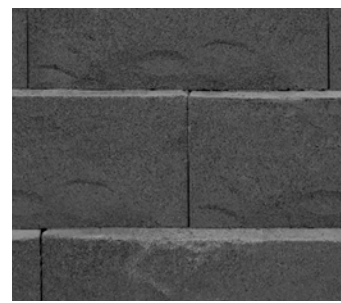

CHARCOAL

# GEOWALL™ PRO



TAN  
Special Order



GREY



CHARCOAL

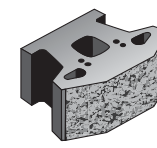

Tri-Plane

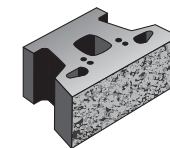

Straight Face

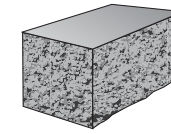

Corner

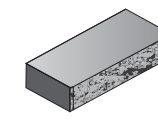

4" Straight Face  
Straight Side Cap

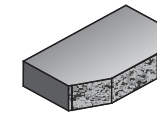

4" Tri-plane  
Straight Side Cap

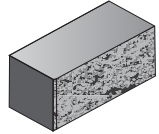

8" Straight Face  
Straight Side Cap

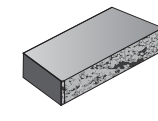

4" Straight Face  
Angled Side Cap

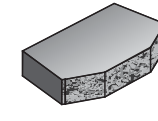

4" Tri-plane  
Angled Side Cap

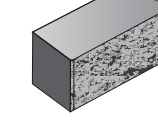

8" Straight Face  
Angled Side Cap



Pins

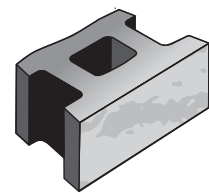

Veteran Pro

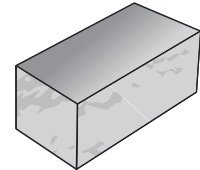

Veteran Pro Corner

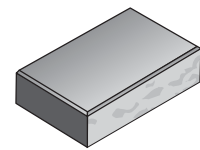

4" Beveled Cap

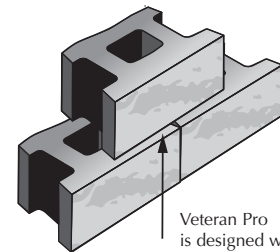

Veteran Pro is designed with a 1 inch setback

Name	Metric Units	U.S. Customary Units	Weight	Units/Pallet
Veteran Pro	457mm W x 273mm L x 203mm H	18" W x 10.75" L x 8" H	64 lbs	36
Veteran Pro Corner	436mm W x 207mm L x 203mm H	17.178" W x 8.187" L x 8" H	60 lbs	50
4" Beveled Cap	457mm W x 305mm L x 102mm H	18" W x 12" L x 4" H	63 lbs	64

Name	Metric Units	U.S. Customary Units	Weight	Units/Pallet
Tri-Plane	457mm W x 304mm L x 203mm H	18" W x 12" L x 8" H	90 lbs	36
Straight Face	457mm W x 304mm L x 203mm H	18" W x 12" L x 8" H	95 lbs	36
Corner	457mm W x 229mm L x 203mm H	18" W x 9" L x 8" H	90 lbs	40
4" Straight Face Straight Side Cap	457mm W x 279mm L x 102mm H	18" W x 11" L x 4" H	60 lbs	64
4" Tri-Plane Face Straight Side Cap	457mm W x 267mm L x 102mm H	18" W x 10.5" L x 4" H	55 lbs	64
8" Straight Face Straight Side Cap	457mm W x 267mm L x 203mm H	18" W x 10.5" L x 8" H	119 lbs	32
4" Straight Face Angled Side Cap	457/356mm W x 279mm L x 102mm H	18/14" W x 11" L x 4" H	60 lbs	64
4" Tri-Plane Face Angled Side Cap	457/356mm W x 267mm L x 102mm H	18/14" W x 10.5" L x 4" H	55 lbs	64
8" Straight Face Angled Side Cap	457/356mm W x 267mm L x 203mm H	18/14" W x 10.5" L x 8" H	119 lbs	32
Pins	12.7mm W x 95mm L	.5" W x 3.75" L	-	-

# GEOWALL™ MAX & MAX II



Tan



TAN



GREY

# GEOWALL™ PLUS



Tan



TAN



GREY

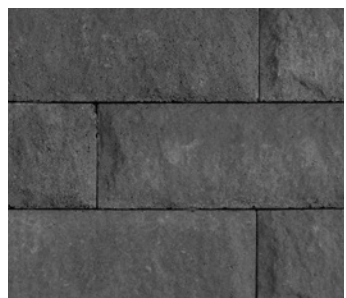

CHARCOAL

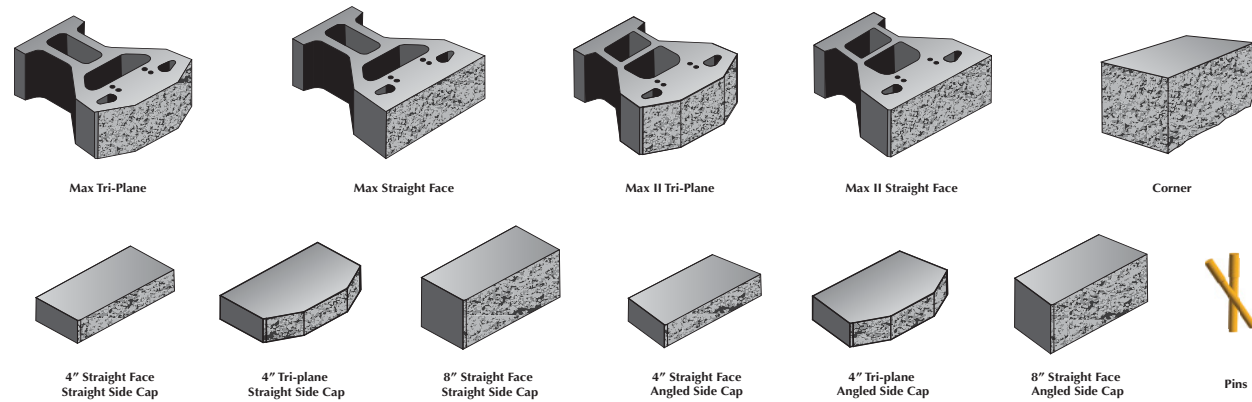

Name	Metric Units	U.S. Customary Units	Weight	Units/Pallet
Max Tri-Plane	457mm W x 546mm L x 203mm H	18" W x 21.5" L x 8" H	110 lbs	30
Max Straight Face	457mm W x 546mm L x 203mm H	18" W x 21.5" L x 8" H	121 lbs	30
Max II Tri-Plane	457mm W x 457mm L x 203mm H	18" W x 18" L x 8" H	105 lbs	30
Max II Straight Face	457mm W x 457mm L x 203mm H	18" W x 18" L x 8" H	115 lbs	30
Corner	457mm W x 229mm L x 203mm H	18" W x 9" L x 8" H	90 lbs	40
4" Straight Face Straight Side Cap	457mm W x 279mm L x 102mm H	18" W x 11" L x 4" H	60 lbs	64
4" Tri-Plane Face Straight Side Cap	457mm W x 267mm L x 102mm H	18" W x 10.5" L x 4" H	55 lbs	64
8" Straight Face Straight Side Cap	457mm W x 267mm L x 203mm H	18" W x 10.5" L x 8" H	119 lbs	32
4" Straight Face Angled Side Cap	457/356mm W x 279mm L x 102mm H	18/14" W x 11" L x 4" H	60 lbs	64
4" Tri-Plane Face Angled Side Cap	457/356mm W x 267mm L x 102mm H	18/14" W x 10.5" L x 4" H	55 lbs	64
8" Straight Face Angled Side Cap	457/356mm W x 267mm L x 203mm H	18/14" W x 10.5" L x 8" H	119 lbs	32
Pins	12.7mm W x 95mm L	.5" W x 3.75" L	-	-

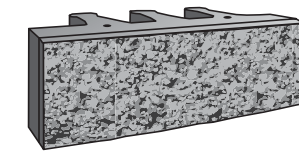

Geowall Plus

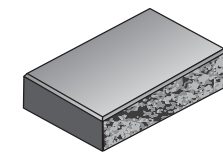

4" Beveled Cap



Pins

Name	Metric Units	U.S. Customary Units	Weight	Units/Pallet
Geowall Plus	610mm W x 292mm L x 203mm H	24" W x 11.5" L x 8" H	90 lbs	36
4" Beveled Cap	457mm W x 305mm L x 102mm H	18" W x 12" L x 4" H	63 lbs	64
Pins	12.7mm W x 95mm L	.5" W x 3.75" L	-	-

# NECESSARIES™ THE KITCHEN™



**DESIGN FEATURE**

Each kit comes with everything you need to build!\*



Necessaries The Kitchen in Santa Fe with Black Pearl granite countertop.



**SANTA FE**



**DESERT**



**BLUESTONE**

A collection of granite-topped cabinets for backyard baking, grilling, dining and entertaining. Elegant, functional and affordable, these quality components and cabinets come with everything you need and are ready to assemble in any configuration you can imagine.



**VISCON WHITE\***  
Granite Countertop



**BLACK PEARL**  
Granite Countertop

\*Outdoor Pizza Oven and Green egg not sold through Basalite.

Printed colors shown in this brochure may vary from actual product colors. We recommend selecting colors from actual product samples. \*Special Order.

# NECESSARIES™ CABINET KITS



**DESIGN FEATURE**  
Affordable and easy to build.



1



2



3

1. Sizzler Grill Cabinet Kit in 40" and 32" (shown) sizes
2. Side Burner Cabinet Kit
3. Prep Center Cabinet Kit



*SANTA FE*



*DESERT*



*BLUESTONE*

# NECESSARIES™ CABINET KITS



**DESIGN FEATURE**

Make your backyard extraordinary.

- 1. Island Cabinet Kit
- 2. Refrigerator Cabinet Kit - Sold Separately
- 3. Utility Cabinet Kit - Smoker\*, Corner, Trash or Two-Drawer kits

\*Smoker not sold through Basalite.



SANTA FE



DESERT



BLUESTONE



# NECESSARIES™ OUTDOOR FIREPLACES



**DESIGN FEATURE**

All kits are expandable to add a  
Hearth or Wood Box later.



1



2



3

- 1. Grand Fireplace Kit, Grand Wood Box Kit and Grand Hearth Kit
- 2. Compact Fireplace Kit, Compact Wood Box Kit and Compact Hearth Kit
- 3. Victorian Fireplace Kit and Victorian Hearth Kit

Also available but not shown Colonial Fireplace Kit and Gas Burning & Log Kit.  
Wood box kits, Gas Burning & Log Kit and Hearth kits sold separately from fireplace kit.

\*Fireplace kit pictures shown may vary from actual kit dimensions as you are able to customize your fireplace to fit your needs.



SANTA FE



DESERT



BLUESTONE

Printed colors shown in this brochure may vary from actual product colors. We recommend selecting colors from actual product samples.

# FIRE PIT KITS



1. Grand Fire Ring Kit\*. Grand Gas Fire Ring Kit also available
2. Victorian Fire Pit Kit with Cooking Grate

\*Cooking grate and Limestone caps sold separately



SANTA FE



DESERT



BLUESTONE



OUTDOOR LIVING KITS / TUMBLED

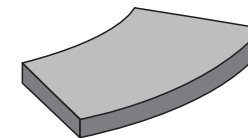

Grand Limestone Caps  
(Sold Separately)

- 52" dia., 2.25" thick
- Sold as a full set of 8 pieces
- Silver Creek chiseled edge in limestone
- Approximate weight 31 lbs

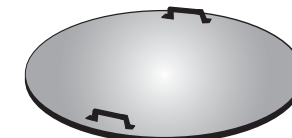

Galvanized Steel Cover  
(Sold Separately)

- Keeps children, animals and debris out
- Heavy galvanized steel covers interior
- With or without slot for cooking grate.
- For Grand Fire Ring

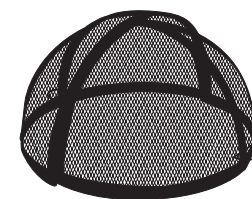

E-Z Access Spark Screen  
(Sold Separately)

- 40" W x 18" H.
- Approximate weight 22 lbs.
- Keeps ash and sparks in, debris out
- Hinged for easy access
- For Grand Fire Ring

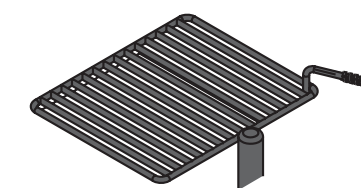

Swivel Cooking Grate  
(Sold Separately)

- Heavy gauge welded steel construction
- ADA compliant
- Removable
- For Grand Fire Ring



Arizona Weathered Oak  
Ceramic Log Set  
(Sold Separately)

- For Grand Gas Fire Ring

# NECESSARIES™ WATER, PILLAR & SEATWALL KITS



**DESIGN FEATURE**

Ideal for when in-ground waterfalls are not suitable.



1



2



3

1. Grand Waterfall Kit. Compact Waterfall Kit also available\*.
2. 20" Pillar with Glass. 24" and 20" without glass also available
3. Lakeland Seatwall Kit. Limestone Caps available and sold separately.

\*Waterfall kit comes with either blue or white LED Lights. Decorative rock not included in waterfall kit.



SANTA FE



DESERT



BLUESTONE

\*The installation instructions and illustrations shown are a basic overview of paver and wall installation methods. Because installation methods vary per product, please refer to the Basalite product specific installation guide, the Standard ICPI installation method, ICPI.org or visit [www.basalite.com](http://www.basalite.com).

## TYPICAL PAVER INSTALLATION\*

1. Excavate unsuitable, unstable or unconsolidated subgrade material and compact the area which has been cleared. Backfill and level with dense graded aggregate suitable for base material (typically 3"-6" for pedestrian/light vehicular traffic and 8"-10" for driveway applications), or as otherwise directed by site engineer/architect/landscape architect.
2. Install edge restraint using concrete curb, concrete toe or edging.
3. Place bedding course of sharp, normal-weight screening or concrete sand to a uniform depth of approximately 1" leveled to grade.
4. Install Basalite Pavers hand tight with joints approximately 1/8". Where required, cut stones with an approved cutter to fit accurately.
5. Tamp pavers with mechanical vibrator, uniformly level, true to grade and free of movement. **TIP: If your pavers have a textured surface, use a compactor with a urethane pad or place a sheet of geotextile or old low-pile carpet, over the surface before compacting to reduce scuffing.**
6. Fill voids in joints by sweeping dry, fine, sharp sand over pavers.

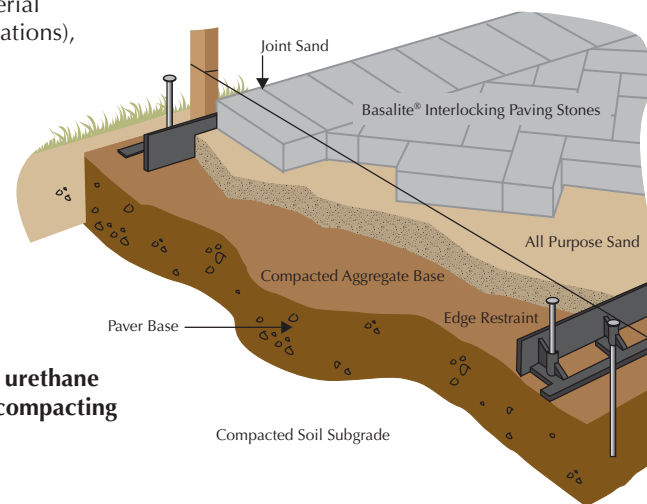

## PERMEABLE PAVER INSTALLATION\*

1. Excavate unsuitable, unstable or unconsolidated subgrade material and compact the area in accordance to ICPI guidelines. Backfill and level Sub-base with No. 2 aggregate 2-1/2" crushed. Backfill and level base layer with No. 57 aggregate 3/4" crushed. The joint material and the foundation (paver bed, subbase, subgrade) must be permeable. 60mm thick pavers may be used in pedestrian applications.
2. Install edge restraint using concrete curb, concrete toe or edging.
3. Place bedding course of No. 8 aggregate 3/8" leveled to grade.
4. Install Pavers in closed assembly with spacer on stone for water drainage. Fill joints with gravel. Where required, cut stones with an approved cutter to fit accurately.
5. Tamp pavers with mechanical vibrator, uniformly level, true to grade and free of movement. **TIP: If your pavers have a textured surface, use a compactor with a urethane pad or place a sheet of geotextile or old low-pile carpet, over the surface before compacting to reduce scuffing.**
6. Fill voids in joints by sweeping dry ASTM No. 8, 89 or 9 stones.

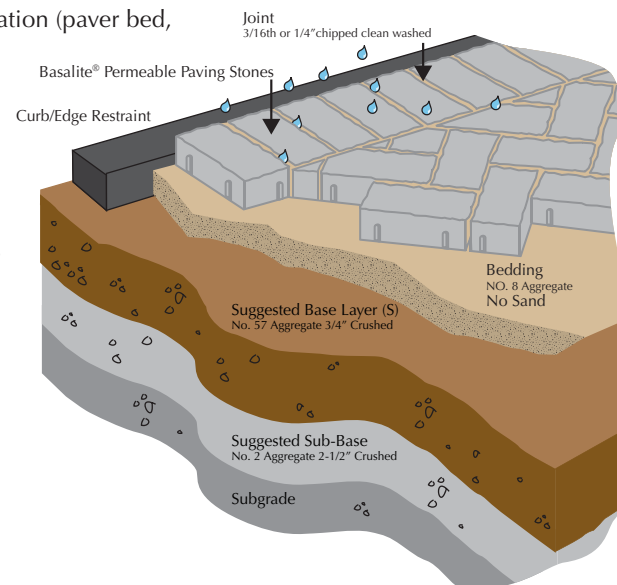

## STONEWALL® II INSTALLATION

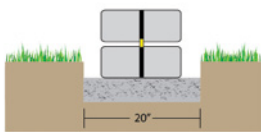
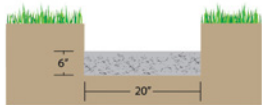

### A. PREPARE BASE LEVELING PAD

Excavate trench 20" wide and 12" deep along the length of wall, assuring depth provides proper unit embedment. On sloped sites, step up 6" to change elevation. Place 6" of 3/4"-1/2" crushed aggregate in the trench. Level, then compact to 95% or greater of standard proctor.

### B. SET & ALIGN BASE COURSE

Starting at lowest elevation, ideally a corner, place and level the block using a string line and 2' level. Follow the suggested patterns as shown, or create your own. Make sure the recess next to the center core is placed top up. Place alignment plugs into the center core following the guidelines in Step C. Lay out the entire bottom course before proceeding to the next courses. Place perforated drain pipe onto leveling pad, behind base course (retaining wall) then backfill, 12" deep, to top of wall with crushed aggregate. Stack additional courses altering the pattern course to course. Repeat the steps to reach the desired wall height.

\*The installation instructions and illustrations shown are a basic overview of wall installation methods. Because installation methods vary per product, please refer to the Basalite® product specific installation guide, the NCMA-SRW installation guide, NCMA.org or visit [www.basalite.com](http://www.basalite.com).

## TYPICAL RETAINING WALL INSTALLATION\*

### A. PREPARE BASE LEVELING PAD

Excavate for the leveling pad. The trench should be at least 12 inches wider than the block you are installing and 6 inches deeper than the height of the block. Use a compactible base material of 3/4-inch minus (with fines) for the leveling pad. The pad must extend at least 6 inches in front of and behind the first course of block, and be at least 6 inches deep after compaction. If the planned grade along the wall front will change elevation, the leveling pad may be stepped up in 6-inch increments to match the grade change. Start at the lowest level and work upward whenever possible. Compact the aggregate and make sure it's level front to back and side to side. Mist lightly with water before compaction.



### B. BASE COURSE

Begin laying block at the lowest elevation of the wall. Place the first block level, front to back and side to side; lay subsequent blocks in the same manner, flush against each other. Make sure they are in full contact with the leveling pad. If the wall is on an incline, don't slope the blocks; step them up so they remain consistently level. For multiple-piece products, use the largest unit, for the base course. Complete the base course before proceeding to the second course. A drainage pipe should be placed at the rear base of first course.

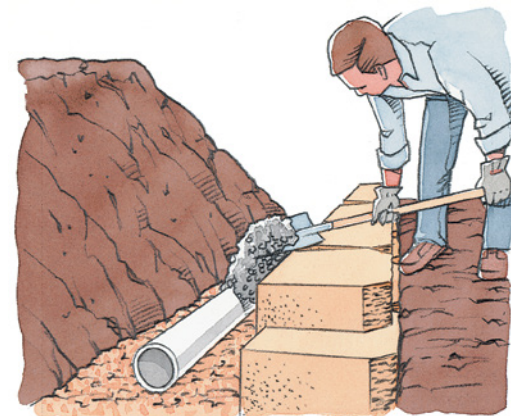

### C. STACK AND FILL

Place the second course of blocks on top of the base course. Remember to keep the wall on bond by placing units in a staggered relationship to the course beneath. Pull each block forward as far as possible to ensure the correct setback. Backfill with drainage aggregate directly behind the block, adding 6 inches at a time, followed by proper compaction. Add soil fill behind the aggregate. Compact before the next course is laid. With the top units dry and clean, stack the caps on top of the final row and use a masonry construction adhesive such as Hardscape Zone adhesive.

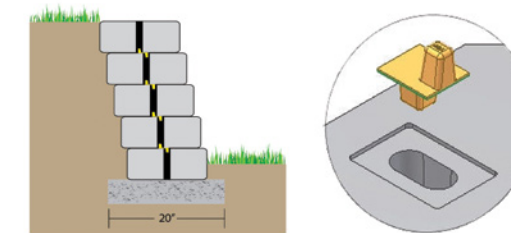
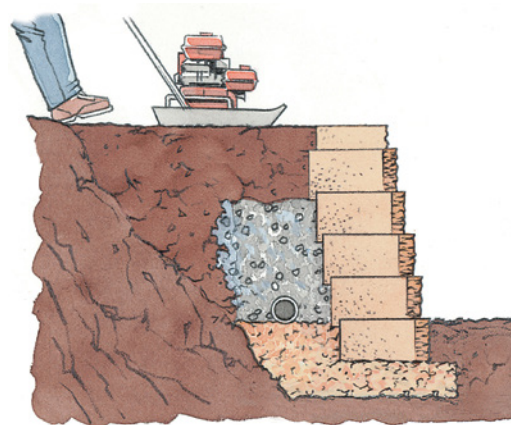

### C. 3-WAY ALIGNMENT PLUG (3WAP)

After stacking the block course, place a 3WAP into the core of each unit, assuring that the flange on the plug rests within the recess adjacent to the core. Orient the plug to achieve your desired wall batter. Use the setback position for retaining walls to achieve a 7.3 degree batter, the vertical position for bench walls, and the reveal position to occasionally highlight a unit.

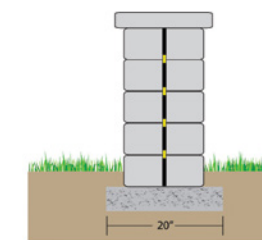

### D. CAPPING THE WALL

Adhere clean and dry cap blocks to the wall using silicon concrete construction adhesive. Place cap flush to the wall face or with an overhang.

# EDGERS



Natural



NATURAL



RED

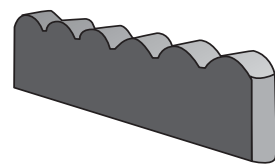

Scalloped Edger

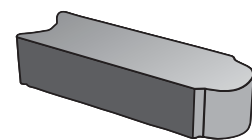

Edgestone



25" Tree Ring (3 pieces)

Name	Metric Units	U.S. Customary Units	Weight	Units/Pallet
Scalloped Edger	51mm W x 610mm L x 152mm H	2" W x 24" L x 6" H	16 lbs	192
Edgestone	98mm W x 311mm L x 98mm H	3.875" W x 12.25" L x 3.875" H	17 lbs	180
25" Tree Ring	51mm W x 635mm L x 152mm H	2" W x 25" L x 6" H	25 lbs	64



## UNIVERSAL PAVER RAIL

Universal Paver Rail is used for straight or curved applications. It has a convenient "one-piece" application to create a permanent and invisible barrier between pavers and other landscape materials.

Sold individually in 7' 8" sections.



## SRW ADHESIVE

SRW Adhesive is formulated for retaining walls, pavers, block, masonry, concrete, aluminum, steel and most common landscaping materials. Superior strength and longevity; works on wet or frozen surfaces; high-temperature compatible; will not freeze and extrudes down to 10°F (-12.22°C); regular and VOC compliant; interior/exterior use.

Box Count	Weight
12	29 oz



## FORM TUBES

Basalite® weather shield concrete forming tubes are designed to hold the full hydrostatic pressure load of concrete in a single continuous pour.

Size	Weight	Size	Weight
6" x 4'	3 lbs	8" x 12'	15 lbs
8" x 4'	5 lbs	10" x 12'	22 lbs
10" x 4'	7 lbs	12" x 12'	25 lbs
12" x 4'	8 lbs	16" x 12'	40 lbs
16" x 4'	13 lbs	18" x 12'	50 lbs
18" x 4'	17 lbs	24" x 12'	75 lbs
24" x 4'	25 lbs		

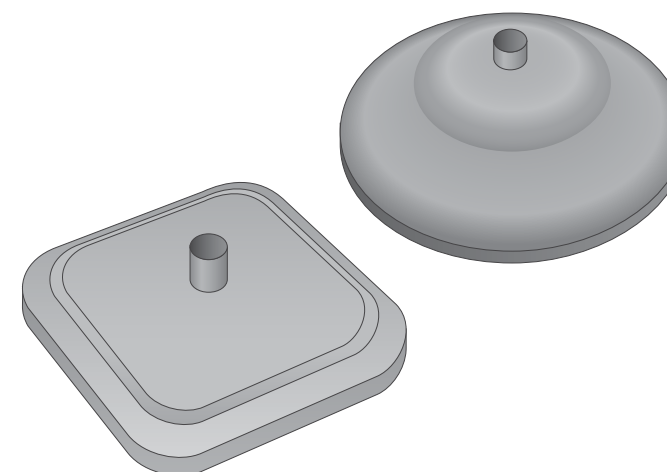

## UMBRELLA STAND

Name	Metric Units	U.S. Customary Units
Round	343mm D x 165mm H	13.5" D x 6.5" H
Square	330mm W x 152mm H x 330mm L	13" W x 6" H x 13" L

Name	Weight	Units /Pallet	Weight /Pallet
Round	40 lbs.	25	1035 lbs.
Square	40 lbs.	25	1035 lbs.

## PACKAGED PRODUCTS



### BASALITE® CONCRETE MIX

For general concrete repair or new construction.

Yield	Bag Weight	Pallet Count
.30 ft <sup>3</sup>	40 lbs.	63
.44 ft <sup>3</sup>	60 lbs.	56
.52 ft <sup>3</sup>	80 lbs.	42
.68 ft <sup>3</sup>	90 lbs.	35



### BASALITE® FAST-SETTING CONCRETE MIX

Sets faster and develops higher strength than regular concrete mix.

Yield	Bag Weight	Pallet Count
.36 ft <sup>3</sup>	50 lbs.	64



### RAPID POST CONCRETE MIX

Sets posts, deck supports and footings. 55 lbs. Bag. 56 per pallet.

Depth	Approx. No. of Bags
18 inch	1 1/4
24 inch	1 1/2
30 inch	1 3/4
36 inch	2

4" x 4" Post with 8" diameter hole



### BASALITE® TYPE S MORTAR

For professionals. Meets ASTM-C270.

Bag Weight	Pallet Count
80 lbs.	42



### BASALITE® TYPE N MORTAR

For professionals.

Bag Weight	Pallet Count
80 lbs.	42



### BASALITE® THIN SET MORTAR

A polymer-modified, bagged, cementitious thin-set powder.

Bag Weight	Pallet Count
50 lbs.	64



### BASALITE® PORTLAND CEMENT TYPE 1L

Create custom concrete, mortar or stucco blends, or add strength to pre-blended mixes.

Bag Weight	Pallet Count
47 lbs.	64
94 lbs.	35



### BASALITE® SAND MIX (3:1)

Suitable for general repair of existing concrete surfaces.

Bag Weight	Pallet Count
60 lbs.	56



### PAVER LOCK

Paver Lock is a polymer sweep sand for pavers.

Bag Weight	Pallet Count
66 lbs.	48



### BASALITE® NATURAL SAND

Kiln dried and washed for multiple uses.

Bag Weight	Pallet Count
50 lbs.	64



### BASALITE® UTILITY SAND

Kiln dried for garden use, cat boxes and construction.

Bag Weight	Pallet Count
60 lbs.	56



### NON-SHRINK FAST SET GROUT

A sanded, cement based expanding grout produced to achieve fast set times and high early strength.

Bag Weight	Pallet Count
55 lbs.	56



### BASALITE® NON-SHRINK GROUT

Use as a dry pack, plastic or flowable high-strength grout.

Bag Weight	Pallet Count
55 lbs.	56



### BASALITE® FINE GROUT

A pre-blended grout for filling masonry cavities, door frames, and concrete patching and grouting.

Bag Weight	Pallet Count
80 lbs.	42



### BASALITE® PLAY SAND

Washed and sterilized for use in sandboxes.

Yield	Bag Weight	Pallet Count
.5 ft <sup>3</sup>	50 lbs.	64

## PACKAGED PRODUCTS



## PACKAGED PRODUCTS



### BASALITE® #0 SUPERFINE DRY SAND

Mix with cement and lime for a very fine mortar.

Bag Weight	Pallet Count
100 lbs.	30



### BASALITE® #1 FINE DRY SAND

Screened to provide optimum filtering capacity.

Bag Weight	Pallet Count
100 lbs.	30



### BASALITE® TUBE SAND

For car weight and traction sand.

Bag Weight	Pallet Count
66 lbs.	40



### ATHLETIC FIELD MARKER

For field marking and jobsites

Bag Weight	Pallet Count
50 lbs.	48



### BASALITE® ASPHALT PATCH

For fast patching of blacktop, walkways, driveways and parking areas.

Bag Weight	Pallet Count
60 lbs.	40



### FAST PATCH

For patching or repairing connections in concrete pipe, precast concrete, overhead beams and floors. Quick patching repairs on sidewalks, curbs and driveways.

0.49 cu. ft. per 55 lb. bag. Controlled 15-minute set time.

Bag Weight / Packaging	Pallet Count
5 lbs. 6 /box	N/A
10 lbs. 4 /box	N/A
55 lbs.	56

## PACKAGED PRODUCTS

For drainage and decorative projects such as atriums, borders and pathways.



### DECOROCK® DESERT SUNSET ROCK

Coverage	Bag Weight	Pallet Count
3 sq. ft. at 2" depth	46 lbs.	49



### DECOROCK® WHITE ROCK

Coverage	Bag Weight	Pallet Count
3 sq. ft. at 2" depth	48 lbs.	49



### DECOROCK® RED LAVA ROCK

Coverage	Bag Weight	Pallet Count
3 sq. ft. at 2" depth	29 lbs.	49



### DECOROCK® GRANITE ROCK

Coverage	Bag Weight	Pallet Count
3 sq. ft. at 2" depth	46 lbs.	49



### BASALITE® 3/4\"/>

Coverage	Bag Weight	Pallet Count
3 sq. ft. at 2" depth	50 lbs.	49



### BASALITE® PEA GRAVEL

Coverage	Bag Weight	Pallet Count
3 sq. ft. at 2" depth	50 lbs.	49

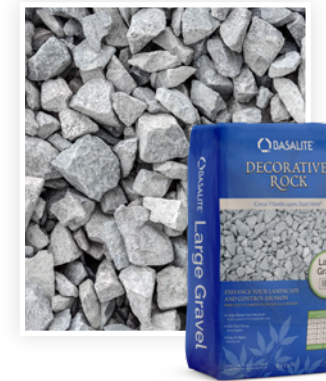

### BASALITE® LARGE GRAVEL

Coverage	Bag Weight	Pallet Count
3 sq. ft. at 2" depth	50 lbs.	49



## PACKAGED PRODUCTS



### FLOOR TOP/FLOOR LEVELER

For concrete surfaces requiring a level, smooth underlayment prior to installing final flooring (tile, carpet, etc). Walk on in 4 hours, install final floor covering within 5 to 8 hours. Must be used with Basalite® "Prime Seal" to ensure bond and maximize coverage.

One 55 lb. sack covers approximately 20.0 ft<sup>2</sup> at 1/4 inch thick.

Pallet Count	Weight / Packaging
-	5 lbs. 6 /box
-	10 lbs. 4 /box
48	55 lbs.



### CONCRETE PATCHER

A self-bonding, pre-blended Portland cement-based patching material for resurfacing worn concrete.

For repairing or resurfacing concrete slabs, driveways, sidewalks, steps, or any worn, chipped or spalled concrete surfaces.

Weight / Packaging
5 lbs. 6 /box
10 lbs. 4 /box



### ANCHORING CEMENT

Pourable compound formulated for the rapid anchoring and repair of fixtures into concrete. Sets in approximately 15 - 30 minutes. 1 lb produces 20 cubic inches.

For rapid anchoring of bolts, screws, posts, railing, reinforcing rods and other fixtures in concrete. May also be used to fill cracks in concrete.

Weight / Packaging
5 lbs. 6 /box

### H2O PLUG

Reacts with moisture within the core structure of concrete to produce a non-soluble crystallized "plug". 1 lb produces 20 cubic inches.

Recommended to damp proof concrete foundations, basement floors, slabs, tanks, and concrete pipe.

Weight / Packaging
5 lbs. 6 /box
10 lbs. 4 /box



## PACKAGED PRODUCTS



### CURE & SEAL

A water-based, semi-gloss acrylic sealer which produces a hard, transparent film to protect concrete surfaces. Smooth concrete: 350 - 600 ft<sup>2</sup>/gal, rough concrete: 200 - 350 ft<sup>2</sup>/gal, concrete pavers: 200 - 350 ft<sup>2</sup>/gal.

For sealing pavers, driveways and sidewalks. Provides a protective barrier from de-icing chemicals, grease, acid, and abrasion.

Size / Packaging
1 Gallon 4 /box



### HIGH GLOSS

A water-based, high-gloss, acrylic sealer which produces a hard, transparent film to protect concrete surfaces. Smooth concrete: 350 - 600 ft<sup>2</sup>/gal, rough concrete: 200 - 350 ft<sup>2</sup>/gal, concrete pavers: 200 - 350 ft<sup>2</sup>/gal.

For sealing pavers, driveways and sidewalks. Provides a protective barrier from de-icing chemicals, grease, acid, and abrasion.

Size / Packaging
1 Gallon 4 /box



### ACRYLIC CONCRETE BONDER

An acrylic polymer bonding agent and primer/sealer. As a bonding agent: 400 - 600 ft<sup>2</sup>/gal. As a primer/sealer: 250 - 400 ft<sup>2</sup>/gal.

Ensures a strong, permanent bond between old and new concrete, mortar, stucco, or plaster. Seal and prepare new concrete to allow the application of paint.

Size / Packaging
1 Gallon 6 /box





**NATURAL - SMOOTH**  
Stock Color



**NATURAL - SPLIT FACE**  
Stock Color

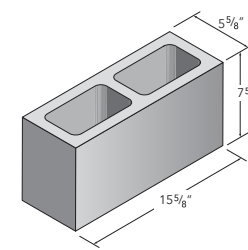

6x8x16  
Standard

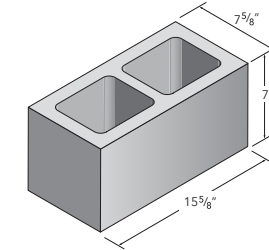

8x8x16  
Standard

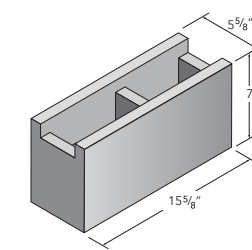

6x8x16  
Bond Beam

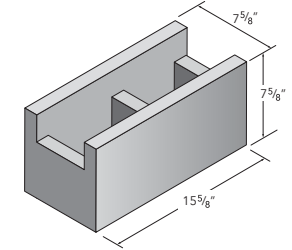

8x8x16  
Bond Beam

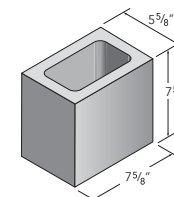

6x8x8  
Half

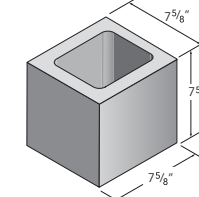

8x8x8  
Half

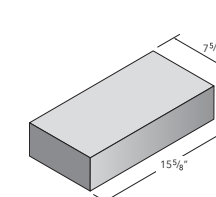

8x4x16  
Solid Block

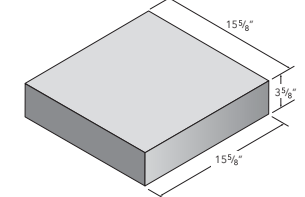

16x4x16  
Solid Base Pad

# BUILDING BLOCKS

Use for construction of masonry walls.  
Available in smooth, split face, ground face or polished  
finish and natural color.



SCAN TO VISIT OUR  
CMU WEBSITE

Name	Metric Units	U.S. Customary Units	Weight	Units /Pallet
6x8x16 Standard	143mm W x 397mm L x 194mm H	5.625" W x 15.625" L x 7.625" H	27 lbs	120
8x8x16 Standard	194mm W x 397mm L x 194mm H	7.625" W x 15.625" L x 7.625" H	40 lbs	90
6x8x16 Bond Beam	143mm W x 397mm L x 194mm H	5.625" W x 15.625" L x 7.625" H	27 lbs	120
8x8x16 Bond Beam	194mm W x 397mm L x 194mm H	7.625" W x 15.625" L x 7.625" H	40 lbs	90
6x8x8 Half	143mm W x 194mm L x 194mm H	5.625" W x 7.625" L x 7.625" H	12 lbs	200
8x8x8 Half	194mm W x 194mm L x 194mm H	7.625" W x 7.625" L x 7.625" H	22 lbs	150
Solid Block (Smooth finish only)	194mm W x 397mm L x 92mm H	7.625" W x 15.625" L x 3.625" H	28 lbs	120
Solid Base Pad (Smooth finish only)	397mm W x 397mm L x 92mm H	15.625" W x 15.625" L x 3.625" H	58 lbs	54

For complete offering of sizes, shapes, colors and finishes, visit [basalite-cmu.com](http://basalite-cmu.com) or contact your Basalite representative or dealer for more information.

## MASONRY / UTILITY

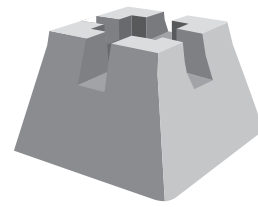

**DECK BLOCK**

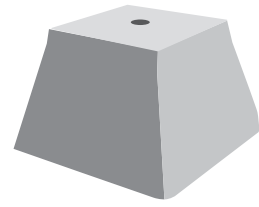

**PIER BLOCK**

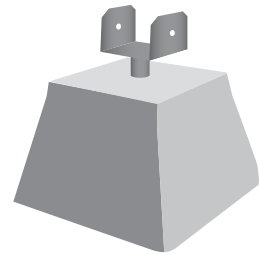

**PIER BLOCK w/  
4x4 BRACKET**

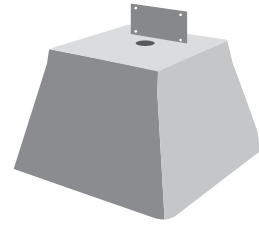

**PIER BLOCK w/  
NAILING PLATE**

Name	Metric Units	U.S. Customary Units	Weight	Units /Pallet
Deck Block	304mm W x 203mm L x 203mm H	12" W x 8" L x 8" H	48 LBS	80
Pier Block	304mm W x 203mm L x 203mm H	12" W x 8" L x 8" H	53 LBS	48
Pier Block w/ 4x4 Bracket	304mm W x 203mm L x 203mm H	12" W x 8" L x 8" H	54 LBS	48
Pier Block w/ Nailing Plate	304mm W x 203mm L x 203mm H	12" W x 8" L x 8" H	53 LBS	48

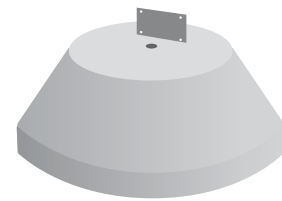
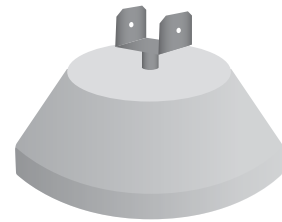
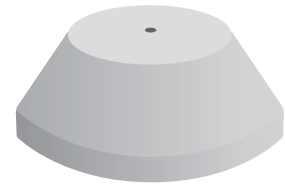

Name	Metric Units	U.S. Customary Units	Weight	Units /Pallet
18" Round Pier	457mm W x 152mm H	18" W x 6" H	85 LBS	30
18" Round Pier w/ 4x4 Bracket	457mm W x 152mm H	18" W x 6" H	86 LBS	17
18" Round Pier w/ Nailing Plate	457mm W x 152mm H	18" W x 6" H	85 LBS	17



### PARKING BUMPER

Metric Units	U.S. Customary Units
165mm W x 146mm H x 1785mm L	6.5" W x 5.75" H x 70.312" L

Weight	Units /Pallet	Weight /Pallet
158 lbs.	30	4775 lbs.



## MASONRY / UTILITY

### CLOVERLEAF SCREEN WALL BLOCK

Build decorative concrete fences or patio privacy screens.

Metric Units	U.S. Customary Units	Weight	Units /Pallet
101mm W x 304mm W x 304mm H	4" W x 12" L x 12" H	22 LBS	120



### SPLASH BLOCK

Divert water away from your foundation. Use at the bottom of downspouts.

Metric Units	U.S. Customary Units	Weight	Units /Pallet
279mm W x 508mm W x 76mm H	11" W x 20" L x 3" H	25 LBS	36



### FOUNDATION VENT WELL

Prevent organic material and plants from clogging foundation vents.

Metric Units	U.S. Customary Units	Weight	Units /Pallet
152mm W x 508mm W x 203mm H	6" W x 20" L x 8" H	40 LBS	36



### FIRE BRICK - GOLD

For wood stove repair or as a base in outdoor fire pits.

Metric Units	U.S. Customary Units	Weight	Units /Pallet
114mm W x 228mm W x 63.5mm H	4.5" W x 9" L x 2.5" H	7.5 LBS	332
114mm W x 228mm W x 31.7mm H	4.5" W x 9" L x 1.25" H	3.75 LBS	664



### DOBIES

Raises rebar to allow consolidation of concrete around the rebar.

Metric Units	U.S. Customary Units	Units /Flat
50mm	2"	15
76mm	3"	15

# THE VERY BEST MADE HERE

Our state-of-the-art Dupont facility enables us to control every step of the manufacturing process, ensuring that the highest standards of quality pavers, walls, outdoor living kits and packaged concrete products are delivered to you.



SCAN TO VISIT  
OUR WEBSITE



SCAN TO DOWNLOAD  
THIS CATALOG



[basalite.com](https://basalite.com)

FOLLOW US



3299 International Place  
Dupont, WA 98327  
253-964-5000